

14302

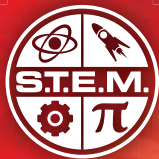

- FR Merci d'imprimer à échelle 1 sans les marges de l'imprimante.
- GB Please print at scale 1 without the printer margins.
- D Den Maßstab 1 bitte randlos drucken.
- IT Stampare la scala 1 senza i margini della stampante.
- E Imprimir a escala 1 sin los márgenes de la impresora.
- P É favor imprimir escala 1 sem as margens da impressora.
- S Skriv ut i skala 1 utan skrivarens marginaler.
- FIN Portaiden painatuksen jälkeen reunat eivät saa näkyä.
- DK Udskriv venligst i målestoksforhold 1 uden printermargener.
- NL É favor imprimir escala 1 sem as margens da impressora.
- GR Σας παρακαλώ τυπώστε την κλίμακα 1 μέσα στα περιθώρια του εκτυπωτή.
- R Пожалуйста, печатайте в масштабе 1:1 без отступов от края.

 **10+**

**Instructions**

**Notice de montage**

**Instrucciones de construcción**

**Bauanleitung**

**Bouwinstructie**

**Istruzioni**

**Instruções**

**Инструкции**

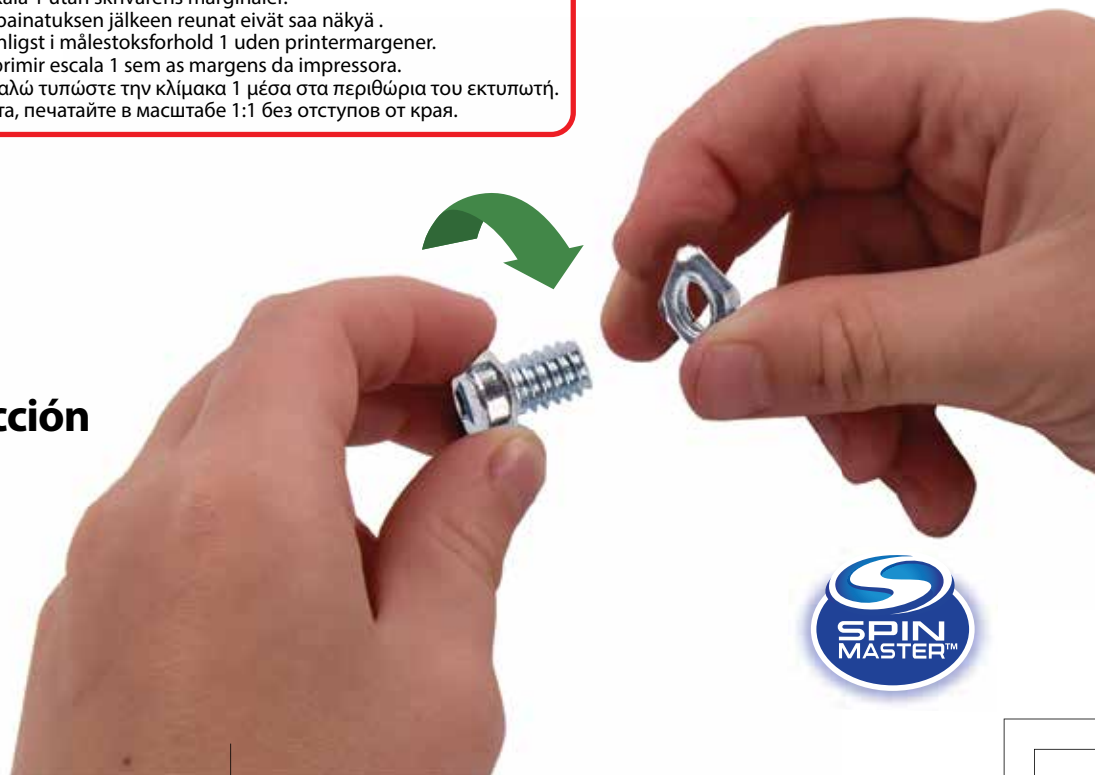

**CONSTRUCTION TIPS**  
 LES ASTUCES DE CONSTRUCTION  
 KONSTRUKTIONSTIPPS  
 LE ASTUZIE DELLA COSTRUZIONE  
 LOS INGENIOS DE LA CONSTRUCCIÓN  
 DICAS PARA A MONTAGEM  
 KOKOOMPANON KIKAT  
 BYGGKNEPEN  
 ET PAR TIPS TIL BYGGEARBEJDET  
 DE FINE KNEEPJES VAN HET BOUWEN  
 Τα έξυπνα κόλπα κατασκευής  
 рекомендации по сборке

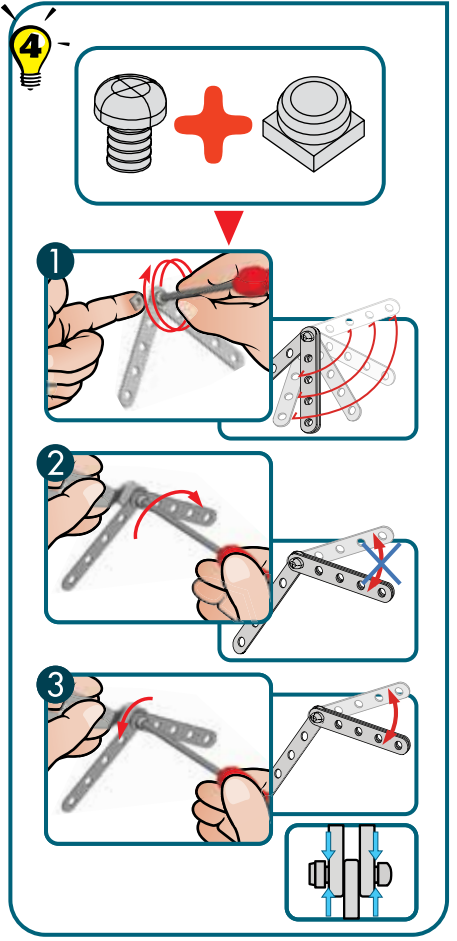
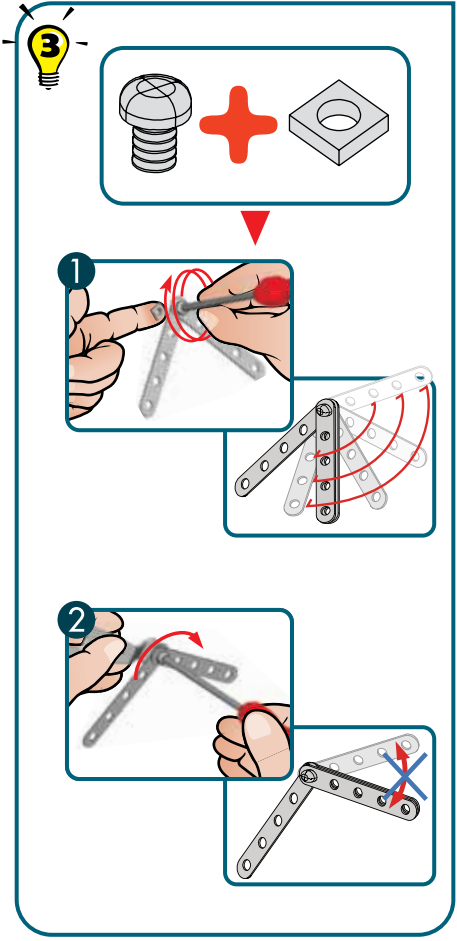
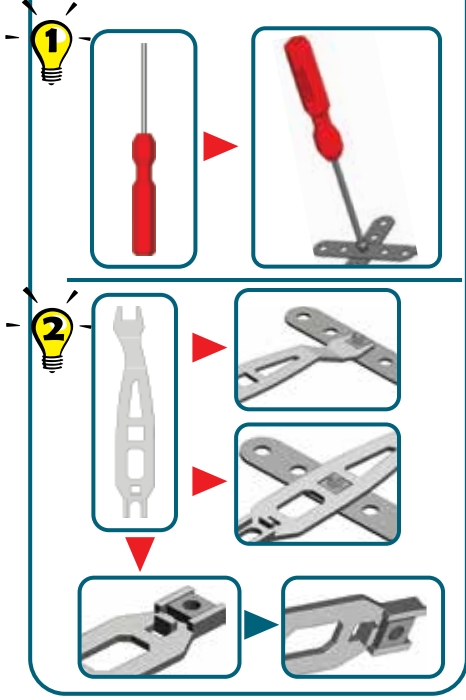





	<b>C889 x1</b>		130 mm 5 1/8"	<b>A315 (0315) x1</b>
	<b>B695 x1</b>		60 mm 2 3/8"	<b>A516 (0316A) x1</b>
	<b>C916 x2</b>		60 mm 2 3/8"	<b>A117 (0016A) x1</b>
	<b>B684 x1</b>		50 mm 2"	<b>A017 (0017) x1</b>
	<b>C778 x2</b>			<b>A105 (0005) x2</b>
	<b>C771 x2</b>			<b>A503 (0103L) x2</b>
	<b>C770 x3</b>			<b>A806 (0806B) x6</b>
	<b>C769 x2</b>			<b>A806 (0806B) x2</b>
	<b>C768 x2</b>			<b>C957 x2</b>
	<b>C775 x2</b>			<b>A426 (0260I) x2</b>
	<b>B051 x3</b>			<b>C920 x1</b>
	<b>A334 (0110C) x1</b>			<b>A418 (0260A) x4</b>
	<b>C372 x3</b>			<b>A421 (0126D) x8</b>
	<b>A420 (0260C) x4</b>			<b>C867 x1</b>
	<b>A420 (0260C) x4</b>			<b>C890 x4</b>
	<b>A812 (0812B) x2</b>			<b>C901 x4</b>
	<b>A811 (0811) x1</b>			
	<b>C330 x3</b>			
	<b>A423 (0260F) x1</b>			<b>A422 (0260E) x2</b>
	<b>A419 (0260B) x2</b>			<b>A631 (0025D3P) x1</b>
	<b>A623 (0023C3P) x6</b>			<b>A238 (0038A) x2</b>
	<b>A238 (0038A) x19</b>			<b>A338 (0038B) x12</b>
	<b>A259 (0059C) x2</b>			<b>A138 (0038) x6</b>
	<b>A337 (0037A) x18</b>			<b>A337 (0037A) x12</b>
	<b>A337 (0037A) x12</b>			<b>A737 (0037H) x5</b>

	38,1mm 1 1/2"	<b>B696 x1</b>	
	28mm 1 1/8"	<b>A611 (0111D) x1</b>	
	28mm 1 1/8"	<b>A611 (0111D) x2</b>	
	25,4mm 1"	<b>A912 (0111E) x1</b>	
	25,4mm 1"	<b>A912 (0111E) x2</b>	
	23mm 15/16"	<b>A347 (0147G) x2</b>	
	23mm 15/16"	<b>A347 (0147G) x1</b>	
	19mm 3/4"	<b>A911 (0111) x2</b>	
	19mm 3/4"	<b>A447 (0147F) x2</b>	
	19mm 3/4"	<b>A447 (0147F) x1</b>	
	14,7mm 37/64"	<b>A247 (0147D) x4</b>	
	14,7mm 37/64"	<b>A247 (0147D) x2</b>	
	12mm 1/2"	<b>A411 (0111A) x3</b>	
	12mm 1/2"	<b>A411 (0111A) x2</b>	
	9,5mm 3/8"	<b>A511 (0111C) x2</b>	
	9,5mm 3/8"	<b>A511 (0111C) x3</b>	
	5,8mm 15/64"	<b>A637 (0037B) x6</b>	
	5,8mm 15/64"	<b>A637 (0037B) x2</b>	
	<b>C994 x1</b>		<b>C993 x1</b>

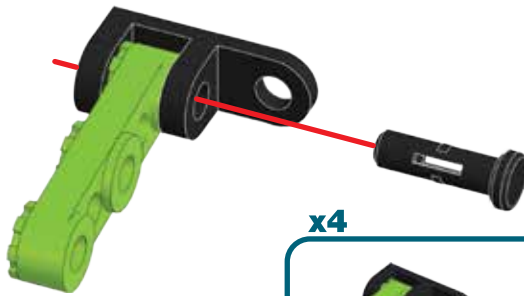

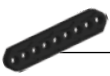
- 1**
-  **A420 (0260C) X4**
  -  **A418 (0260A) X4**
  -  **A421 (0126B) X4**



- 2**
-  **B051 X1**
  -  **A503 (0103L) X2**
  -  **A247 (0147M) X1**  
14,7 mm 37/64"
  -  **A337 (0037A) X1**

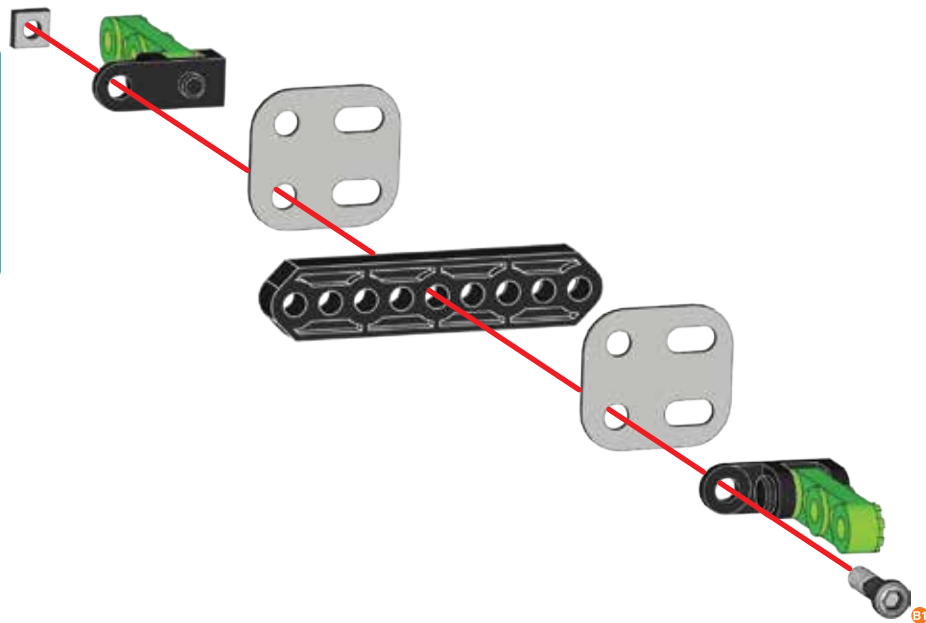

-  **B1** **1:1**



**3** ①+

	<b>A420 (0260C) X 1</b>
	<b>A247 (0147B) X 1</b>
	<b>A337 (0037A) X 1</b>

	<b>B1</b>	<b>1:1</b>
--	-----------	------------

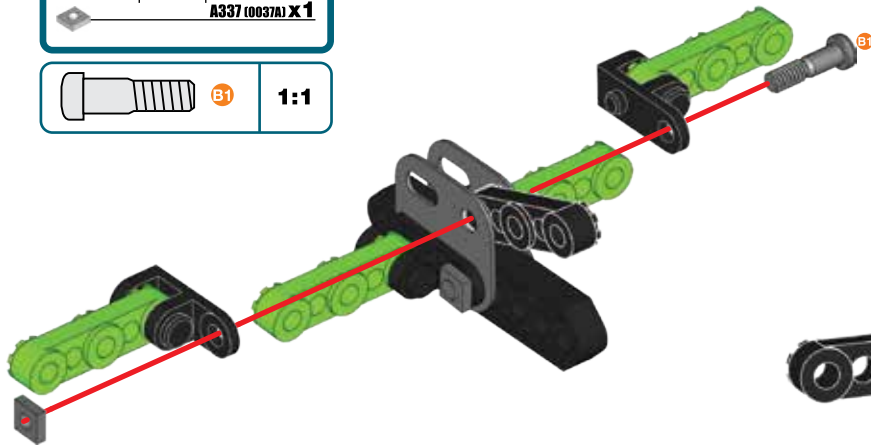

**4**

	<b>A420 (0260C) X 2</b>
	<b>A347 (0147C) X 1</b>
	<b>A337 (0037A) X 1</b>

	<b>B3</b>	<b>1:1</b>
--	-----------	------------

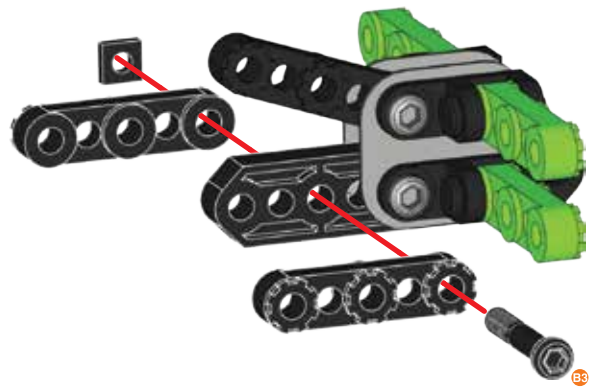



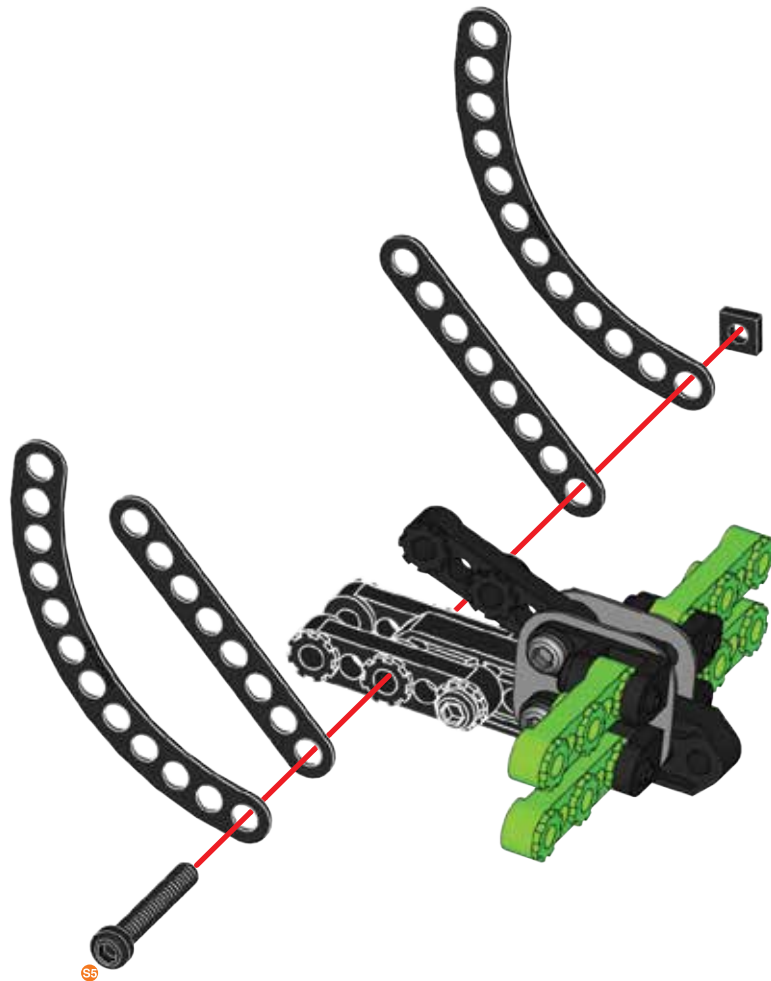

**5**

	<b>C78 X 2</b>
	<b>C70 X 2</b>
	<b>A912 (011E) X 1</b>
	<b>A337 (0037A) X 1</b>

	<b>S5</b>	<b>1:1</b>
--	-----------	------------





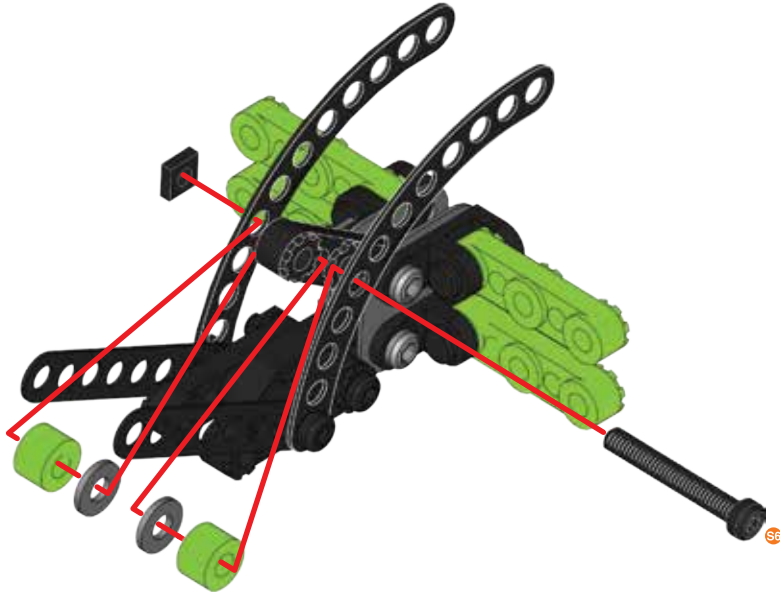

**6**

	<b>A238 (0038A) X2</b>
	<b>A611 (0111D) X1</b> 28 mm   1 1/8"
	<b>A337 (0037A) X1</b>
	<b>A138 (0038) X2</b>

	<b>S6</b>	<b>1:1</b>
---	-----------	------------





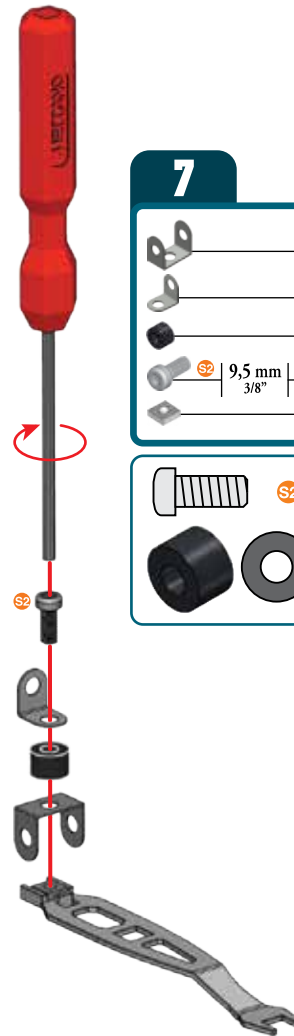

**7**

	<b>A811 (0811A) X1</b>
	<b>C330 X1</b>
	<b>A238 (0038A) X1</b>
	<b>A511 (0111C) X1</b> 9,5 mm   3/8"
	<b>A337 (0037A) X1</b>

	<b>S2</b>	<b>A238</b>
---	-----------	-------------



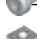

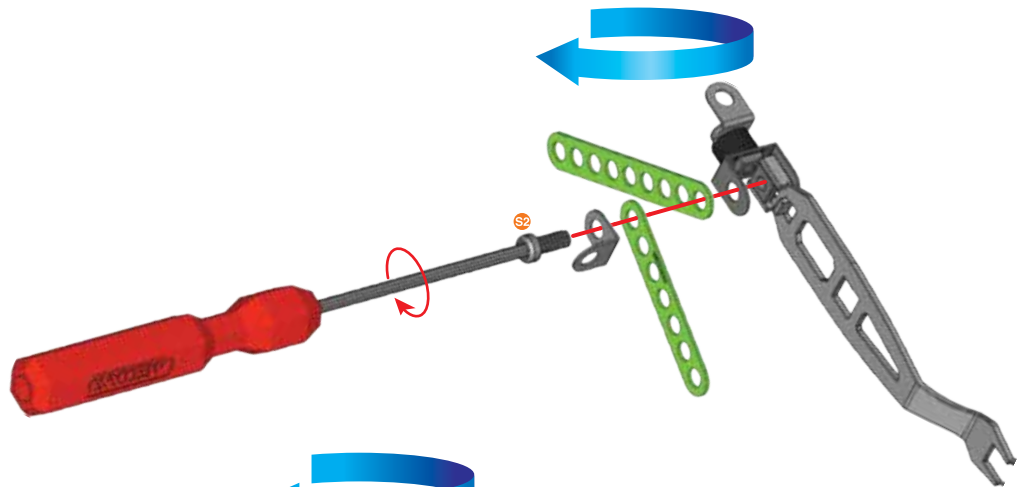

**8** (7)+

	<b>C771 X1</b>
	<b>C769 X1</b>
	<b>C330 X1</b>
	<b>A511 (0111C) X1</b> 9,5 mm   3/8"
	<b>A337 (0037A) X1</b>

	<b>S2</b>	<b>1:1</b>
---	-----------	------------



**9**

	<b>C771 X1</b>
	<b>C769 X1</b>
	<b>C330 X1</b>
	<b>A511 (0111C) X1</b> 9,5 mm   3/8"
	<b>A337 (0037A) X1</b>

	<b>S2</b>	<b>1:1</b>
---	-----------	------------

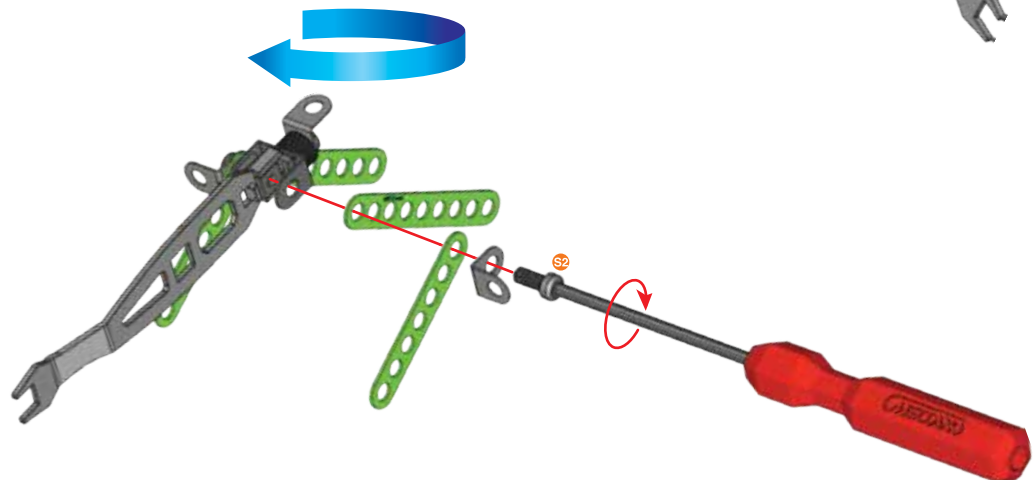

**10**

	<b>B684 x 1</b>
	<b>A637 (0037B) x 1</b>
	<b>A337 (0037A) x 1</b>

	<b>S1</b>	<b>1:1</b>
--	-----------	------------

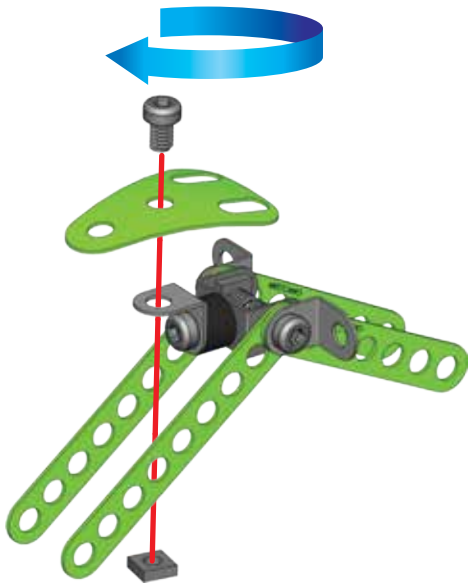

**11** **6 + 10 +**

	<b>A637 (0037B) x 1</b>
	<b>A337 (0037A) x 1</b>

	<b>S1</b>	<b>1:1</b>
--	-----------	------------

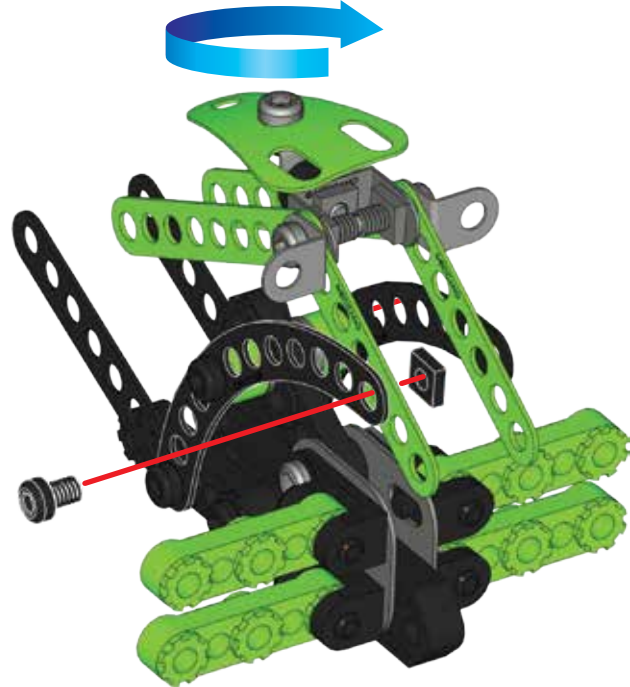

**12**

	<b>A637 (0037B) x 1</b>
	<b>A337 (0037A) x 1</b>

	<b>S1</b>	<b>1:1</b>
--	-----------	------------



**13**

	<b>A637 (0037B) x 1</b>
	<b>A337 (0037A) x 1</b>

	<b>S1</b>	<b>1:1</b>
--	-----------	------------



**14**

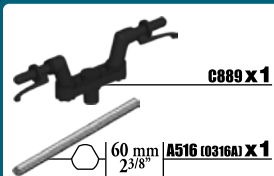

C889 x1  
60 mm | 2 3/8" | A516 (0316A) x1

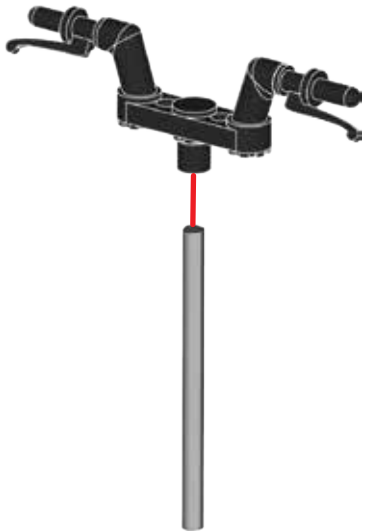

**15**

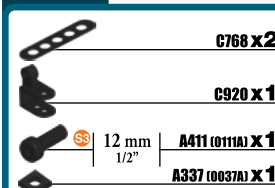

C768 x2  
C920 x1  
12 mm | 1/2" | A411 (0111A) x1  
A337 (0037A) x1

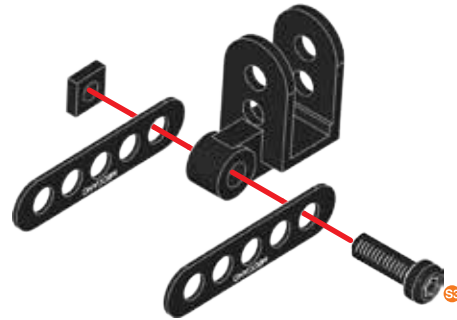

**16**



A334 (0110C) x1  
A806 (0806B) x2  
A338 (0038B) x1  
12 mm | 1/2" | A411 (0111A) x1  
A337 (0037A) x1

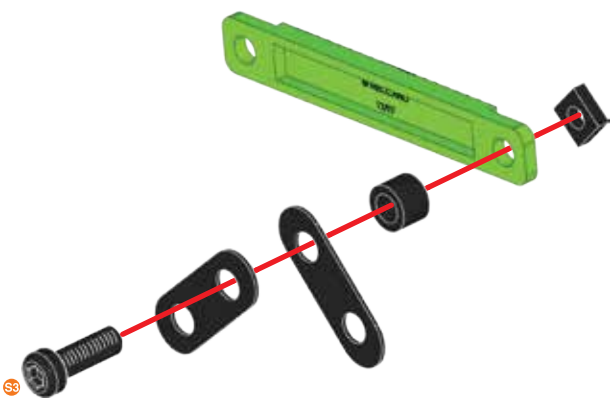

**17**

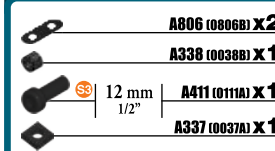

A806 (0806B) x2  
A338 (0038B) x1  
12 mm | 1/2" | A411 (0111A) x1  
A337 (0037A) x1

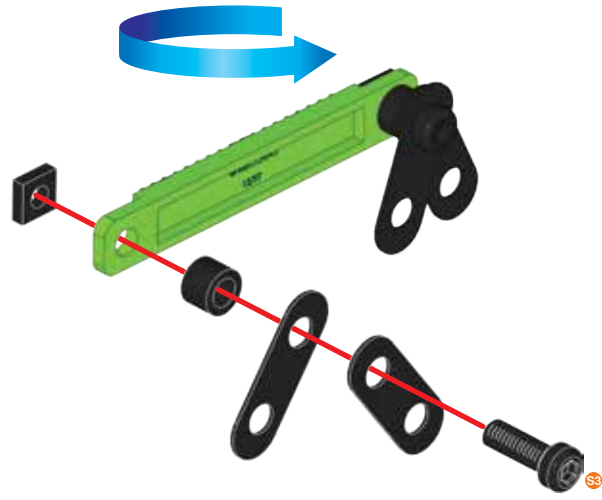

**18**

	<b>A426 (02601) X 1</b>
	<b>A637 (0037B) X 1</b>
	<b>A337 (0037A) X 1</b>

	<b>S1</b>	<b>1:1</b>
--	-----------	------------

**19**

	<b>A426 (02601) X 1</b>
	<b>A637 (0037B) X 1</b>
	<b>A337 (0037A) X 1</b>

	<b>S1</b>	<b>1:1</b>
--	-----------	------------

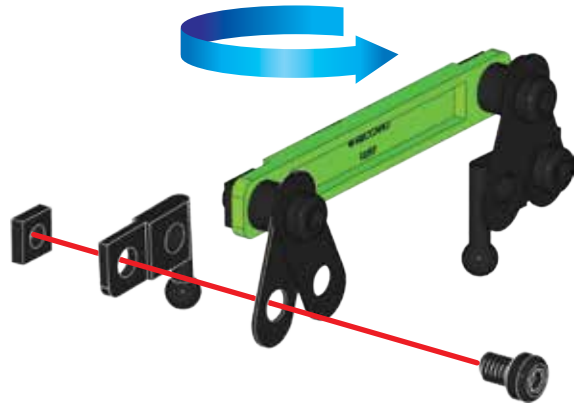
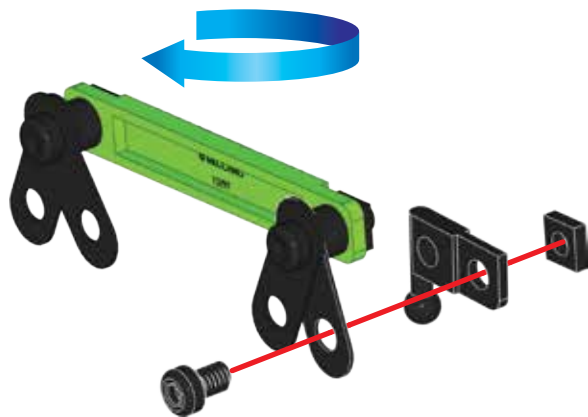

**20**

**15 + 19**

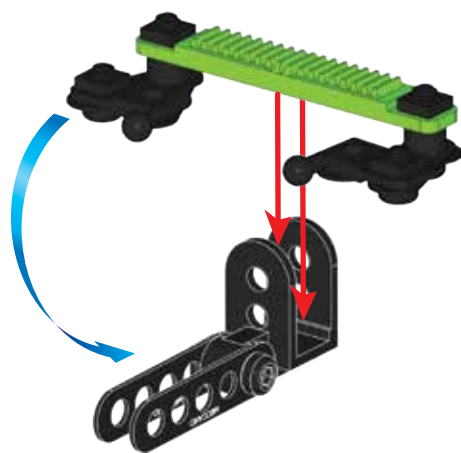

**21** **14 + 20**

	<b>A631 (002503P) X 1</b>
	<b>C867 X 1</b>

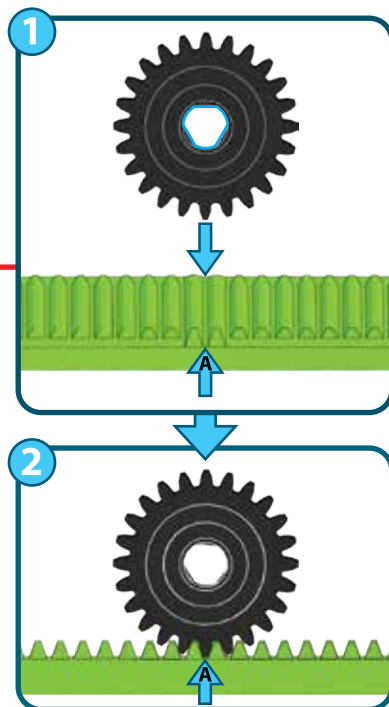
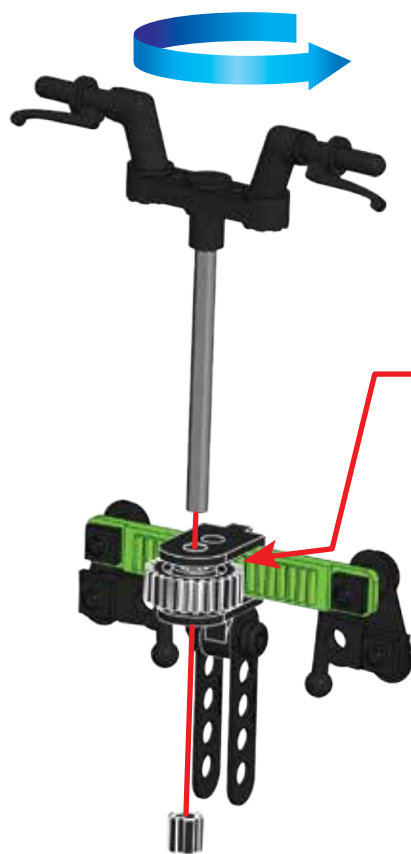



22

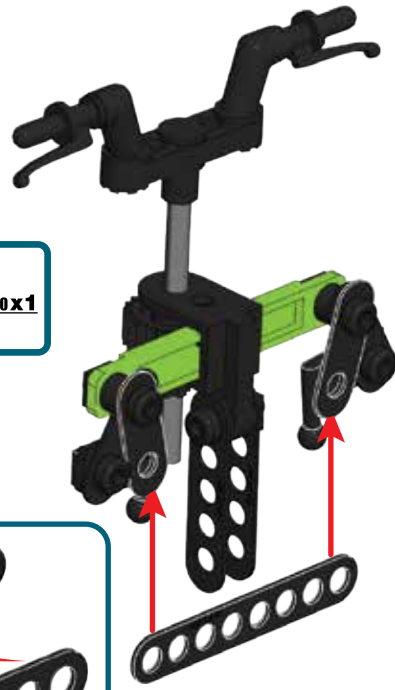
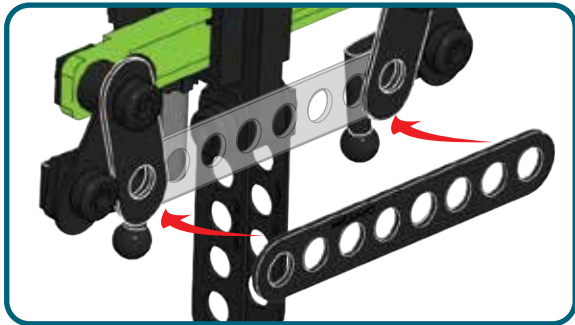

23

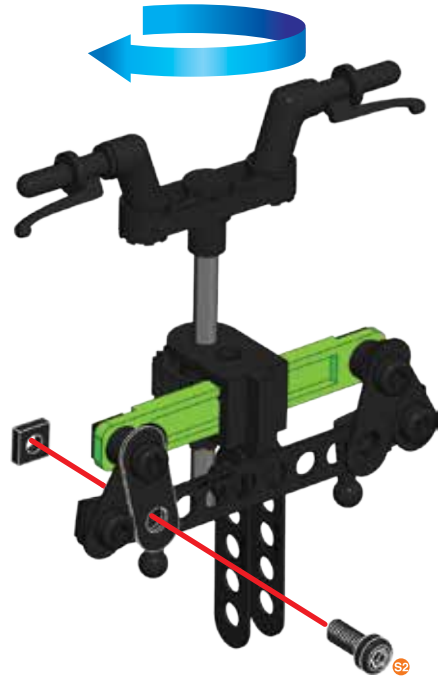
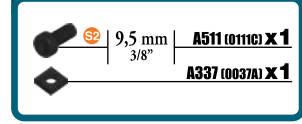

24

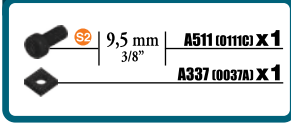

25

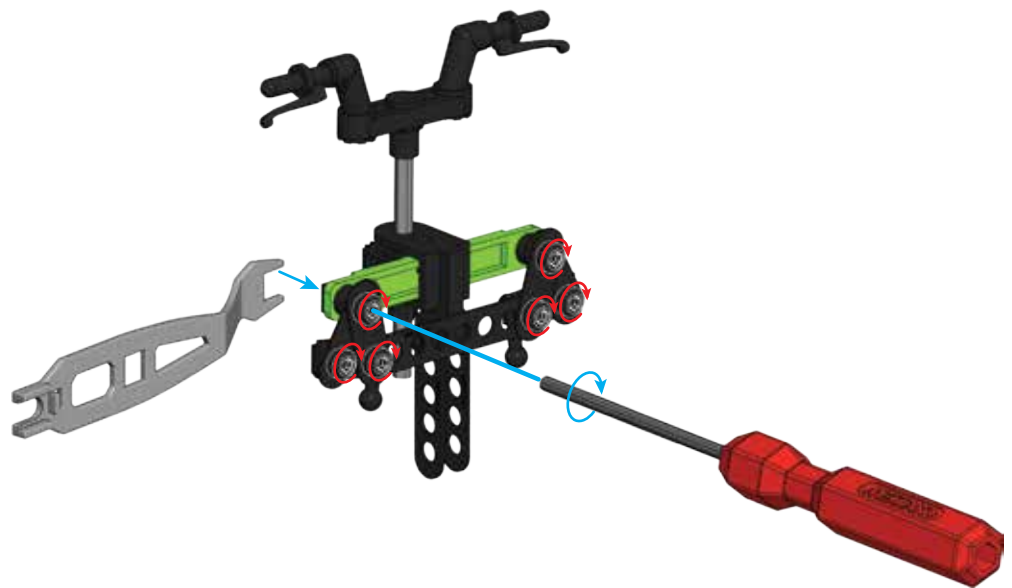

**26**  
 13 + 25

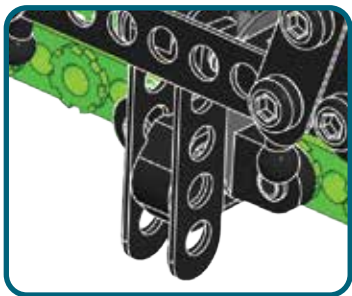
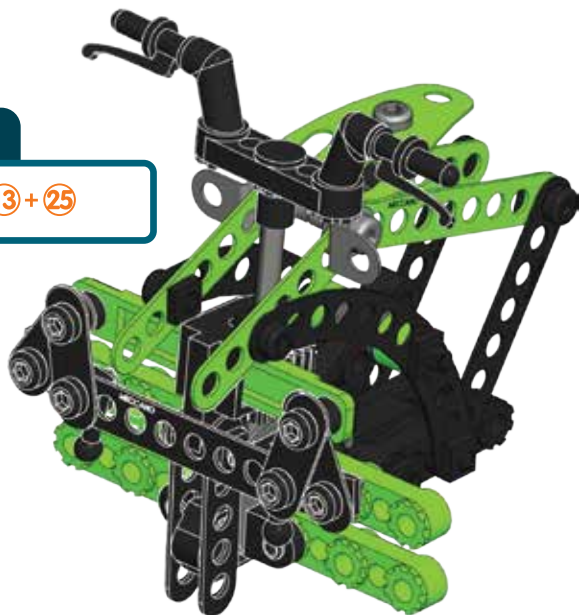

**27**

	<b>C775 x2</b>
	<b>A238 (0038A) x2</b>
	<b>A611 (0111D) x1</b> 28 mm 1 1/8"
	<b>A337 (0037A) x1</b>

**A238**

1:1

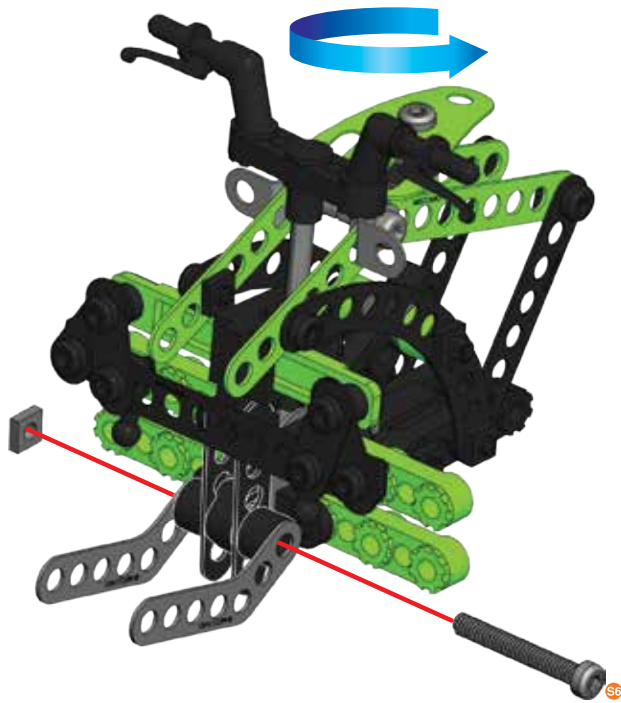



**28**

	<b>A419 (0260B) x1</b>
	<b>A421 (0126D) x1</b>



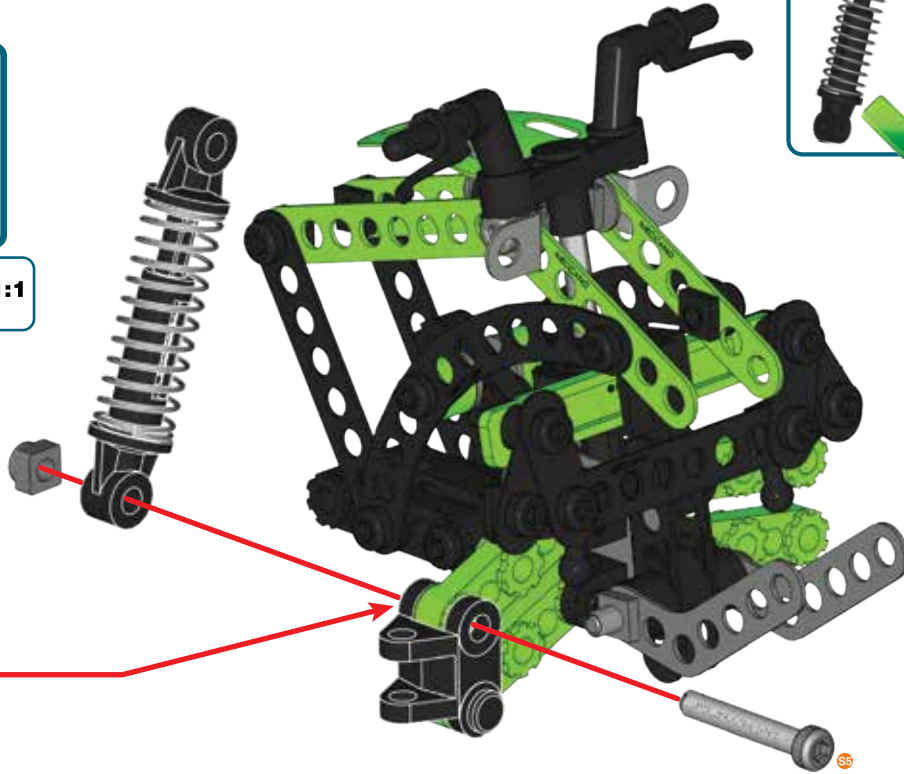
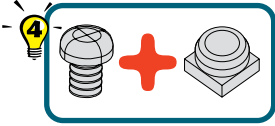
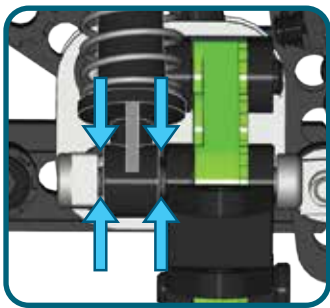
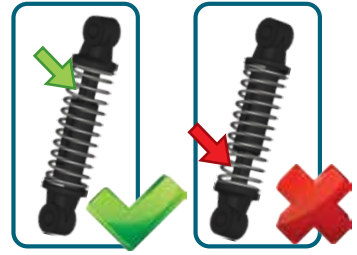
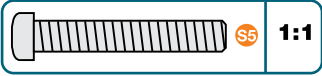

29

-  C372 x 1
-  25,4 mm | A912 (0111E) x 1
-  A737 (0037H) x 1



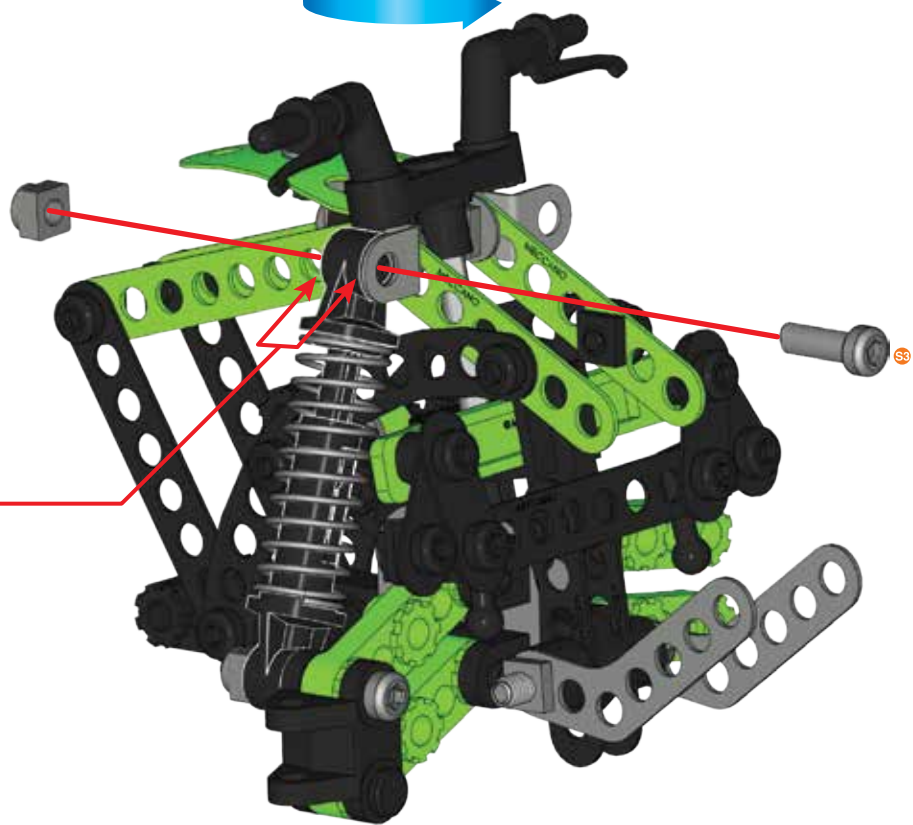
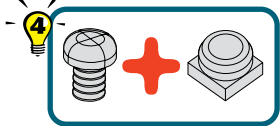
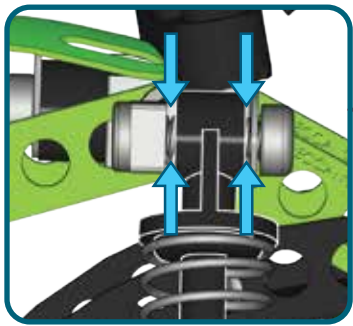

30

-  12 mm | A411 (0111A) x 1
-  1/2" | A737 (0037H) x 1



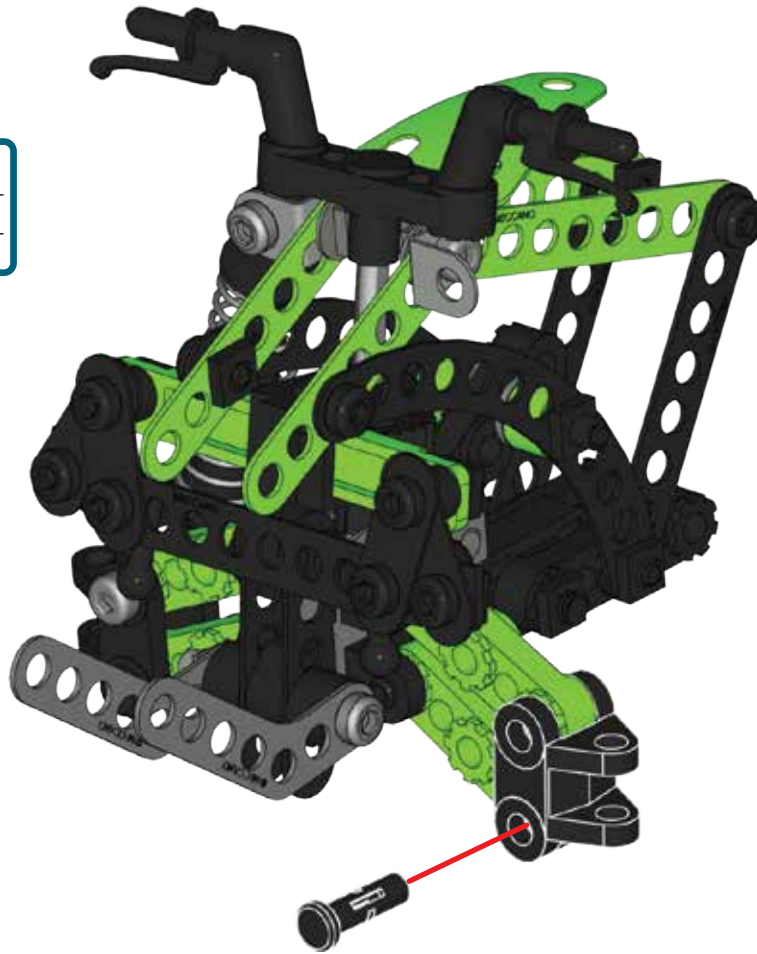

31

-  A419 (0260B) X 1
-  A421 (0126D) X 1



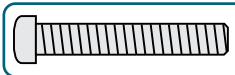

32

-  C372 X 1
-   $\frac{25,4}{1}$  mm | A912 (0111E) X 1
-  A737 (0037H) X 1

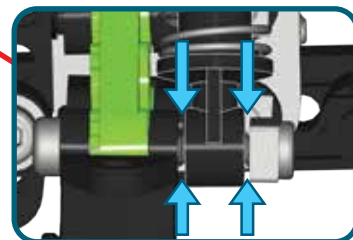
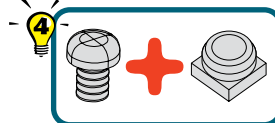
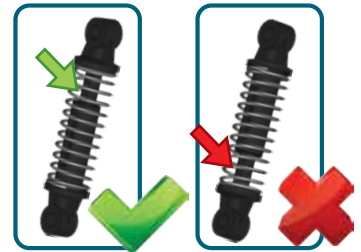
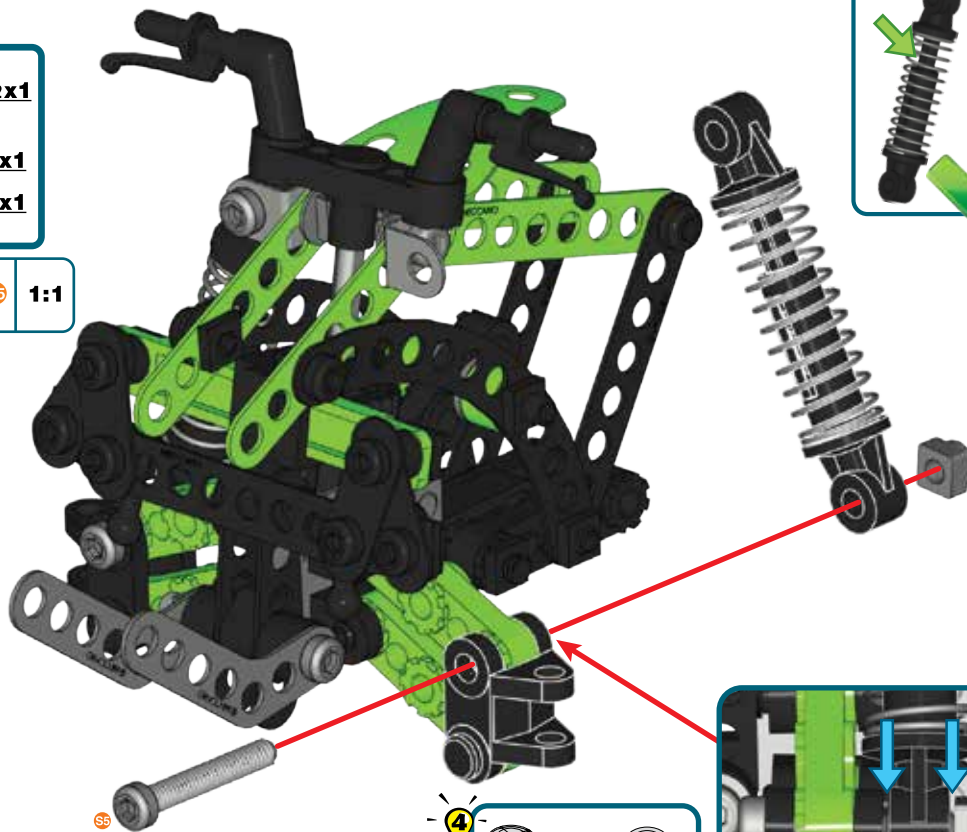
 SS 1:1



**33**





	12 mm 1/2"	<b>A411 (0111A) X 1</b>
		<b>A737 (0037H) X 1</b>

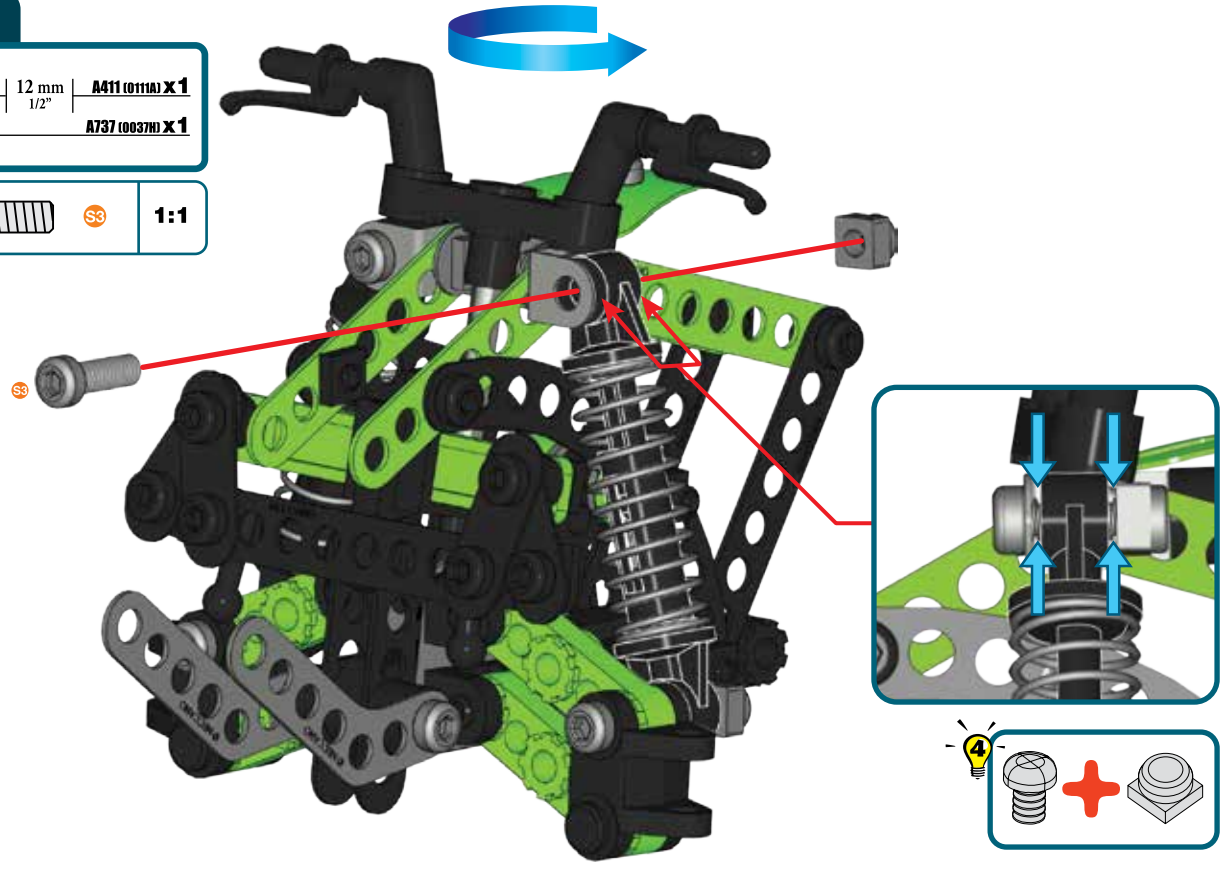

	<b>S3</b>	<b>1:1</b>
---	-----------	------------



**34**



		<b>A423 (0260F) X 1</b>
		<b>A338 (0038B) X 2</b>
	23 mm 15/16"	<b>A347 (0147G) X 1</b>
		<b>A337 (0037A) X 1</b>

	<b>S3</b>	<b>1:1</b>
		<b>A338</b>

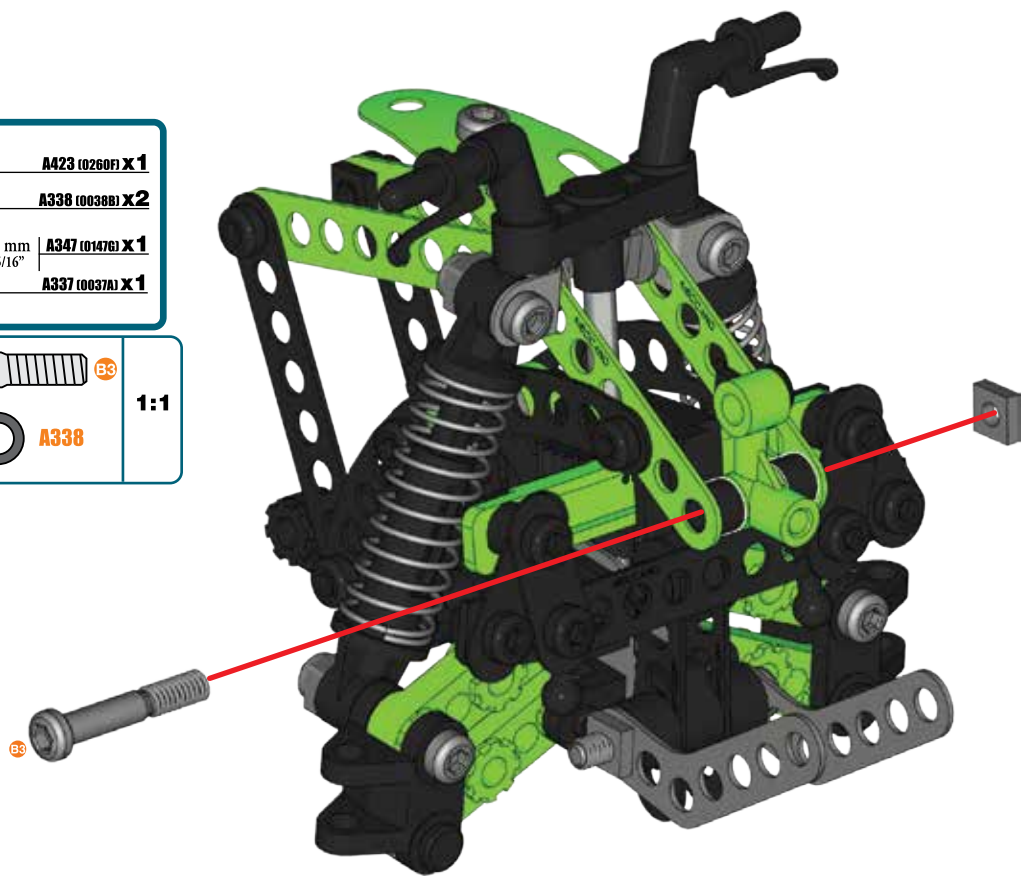

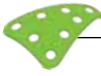

35

-  **B695 x 1**
-  | 5,8 mm | **A637 (00378) x 1**  
15/64"
-  | **A138 (00388) x 1**

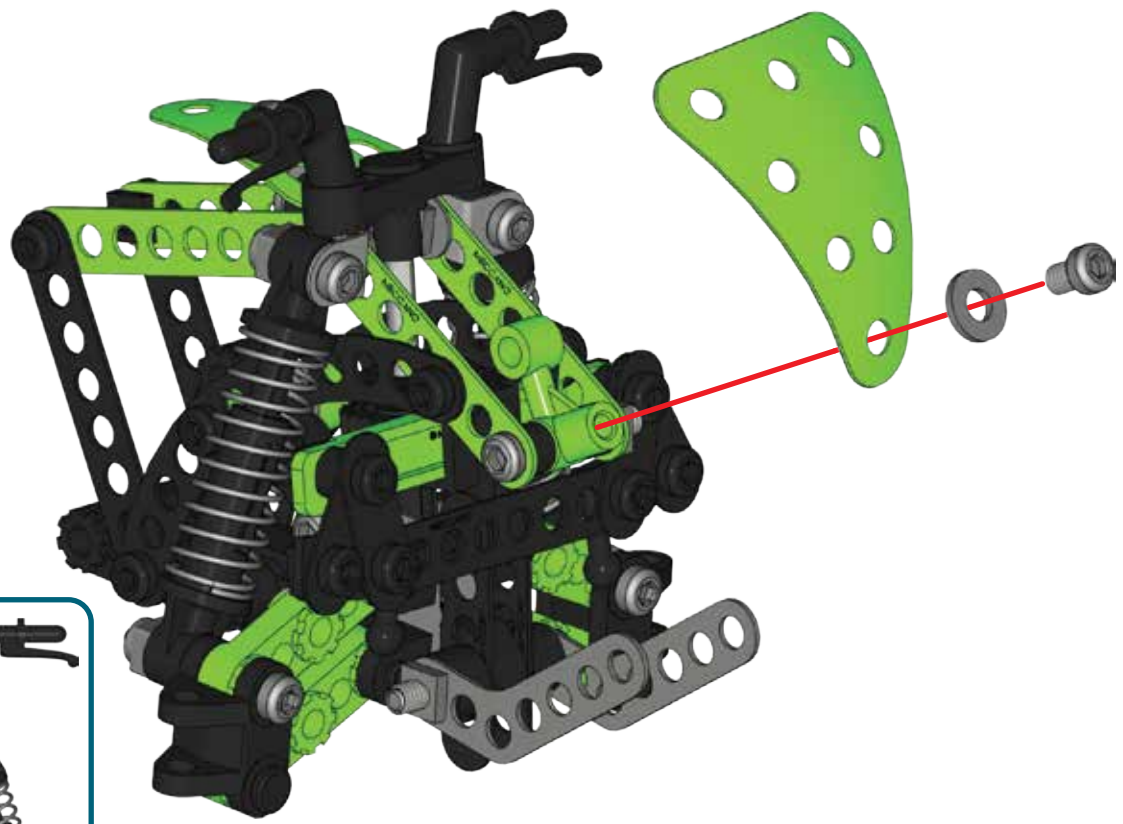
 **S1** | **1:1**



36

-  | **A422 (0260F) x 2**
-  | **A421 (0126D) x 2**



37



C957 x 1

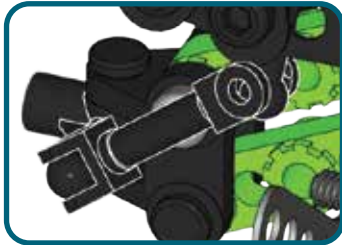
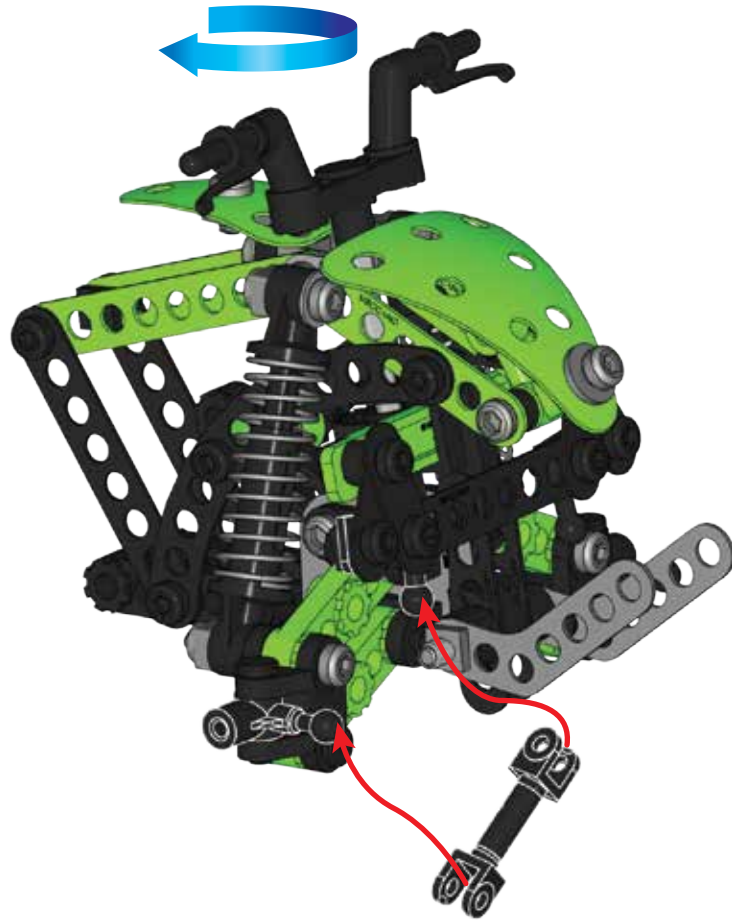

38



C957 x 1

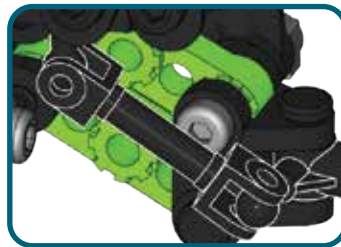
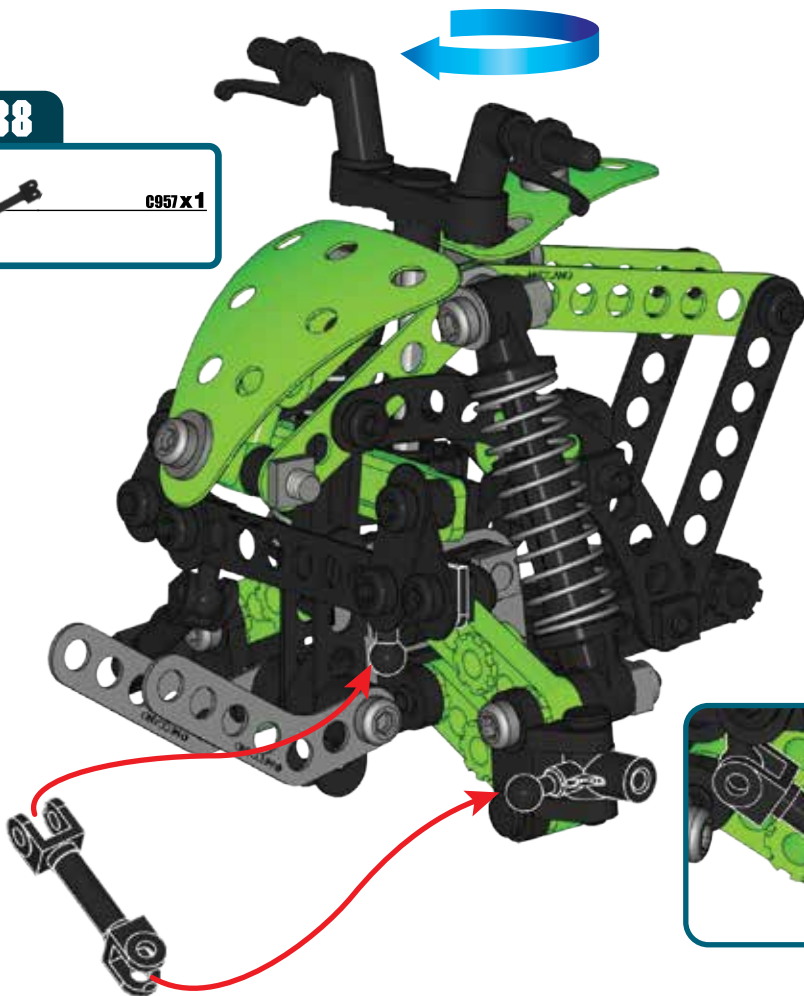

39

- A806 (0806B) X2
- A238 (0038A) X3
- S6 | 28 mm | A611 (0111D) X1  
1 1/8"
- A337 (0037A) X1

- S6
- A238
- 1:1

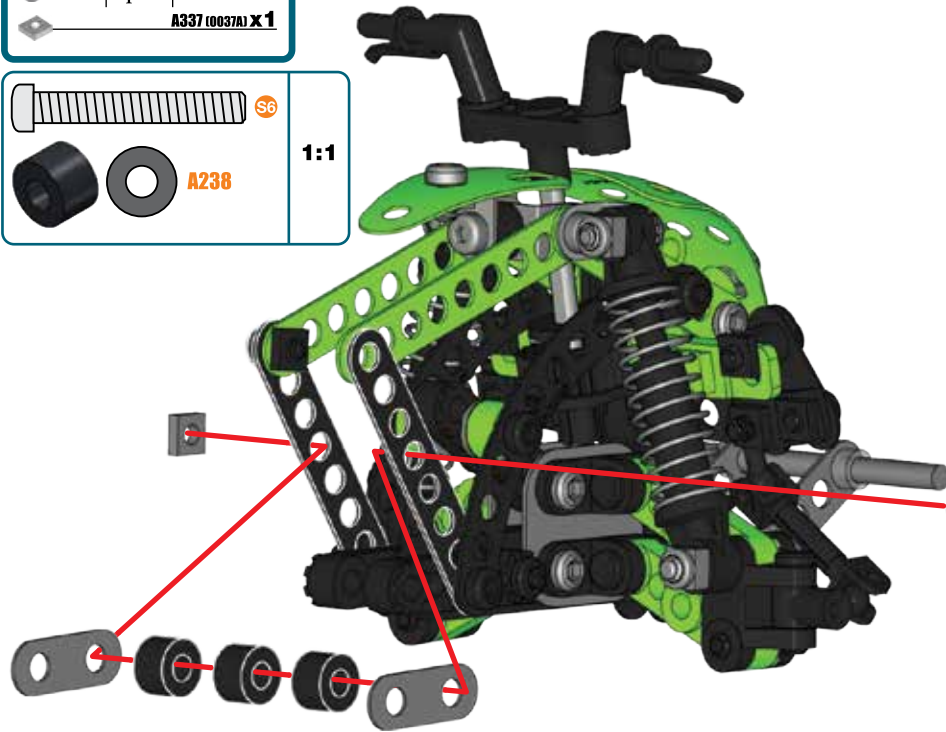

40

- C916 X1
- A420 (0260C) X1
- A812 (0812B) X1
- S4 | 19 mm | A911 (0111D) X1  
3/4"
- A337 (0037A) X1

- S4
- 1:1

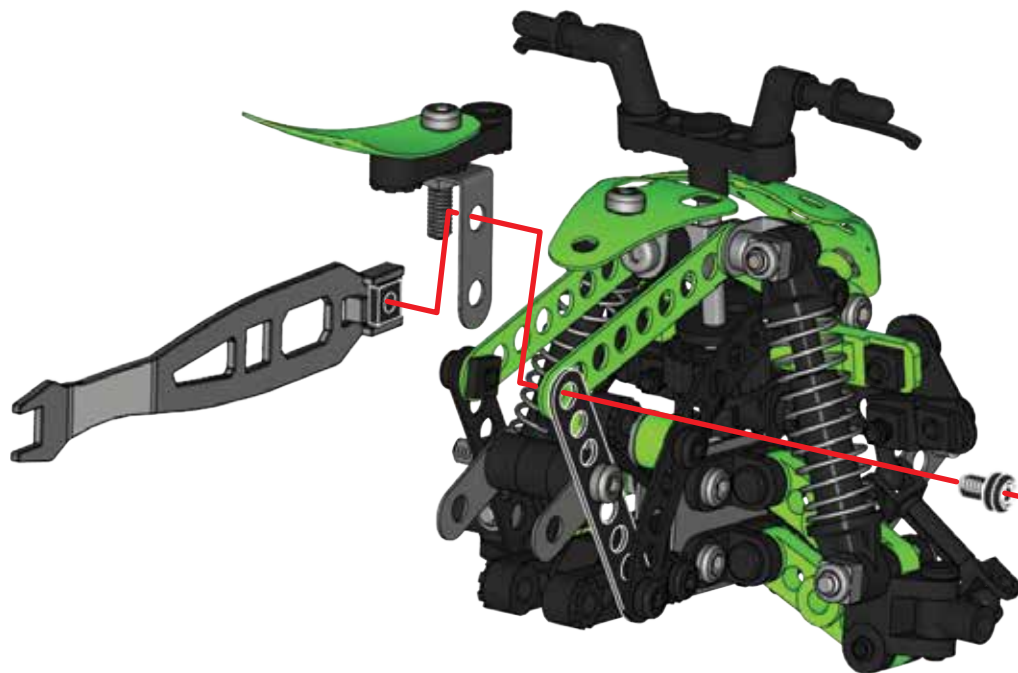
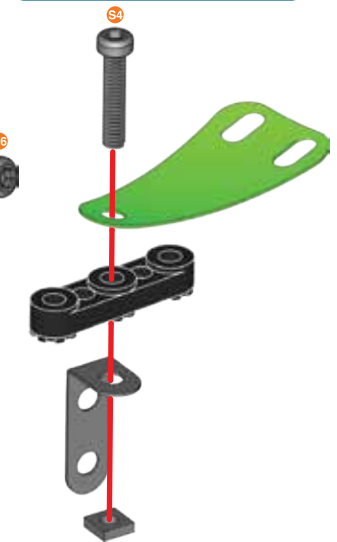

41

39 + 40 +

- S1 | 5,8 mm | A637 (0037B) X1  
15/64"
- A337 (0037A) X1

- S1
- 1:1



42

	<b>B051 X 1</b>
	<b>A238 (0038A) X 1</b>
	<b>A911 (011D) X 1</b>
	<b>A337 (0037A) X 1</b>

	<b>S4</b>
	<b>A238</b>
<b>1:1</b>	

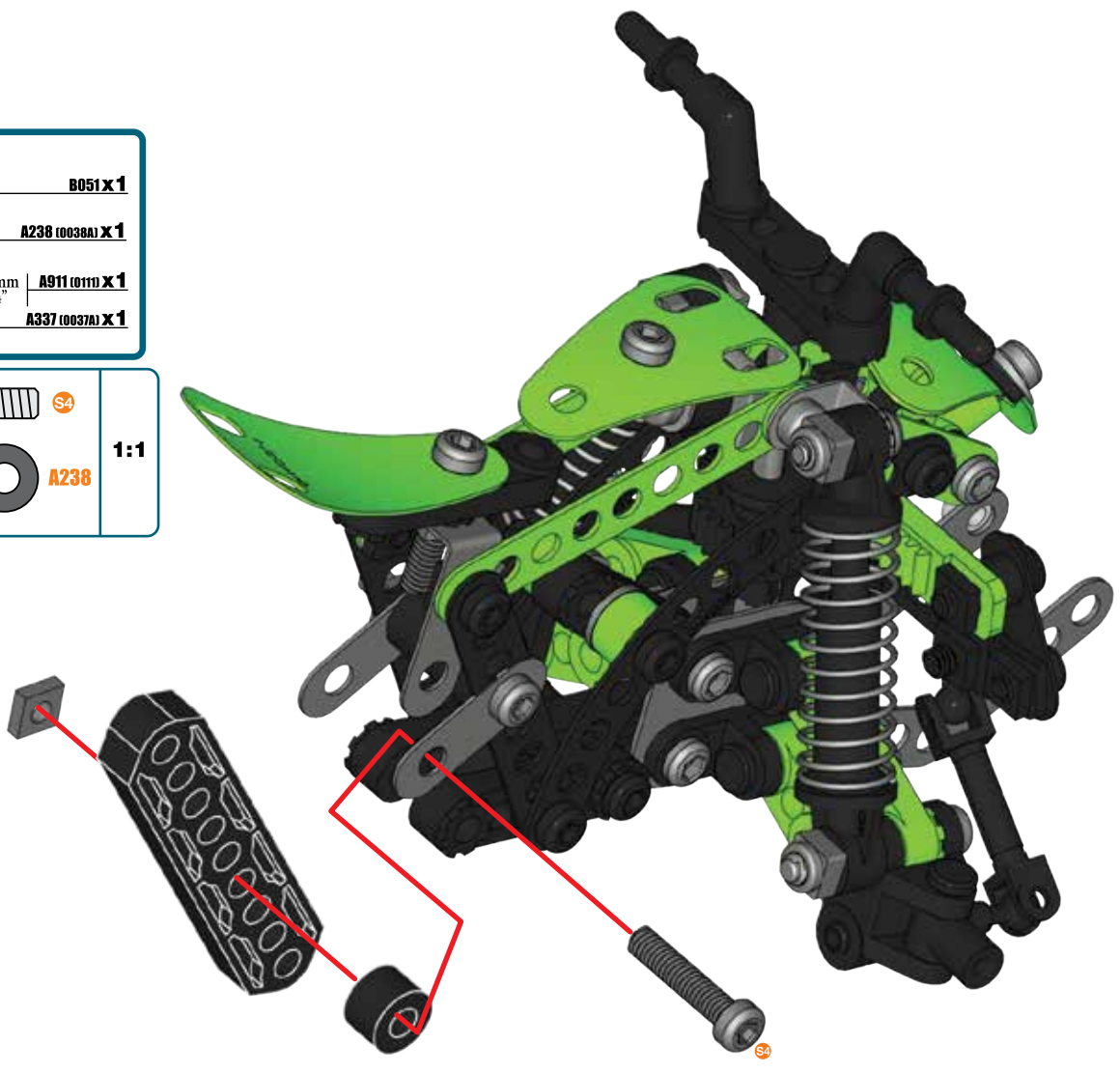

43

	<b>A117 (0016A) X 1</b>
	<b>A623 (0023P3E) X 1</b>

	<b>1:1</b>
--	------------

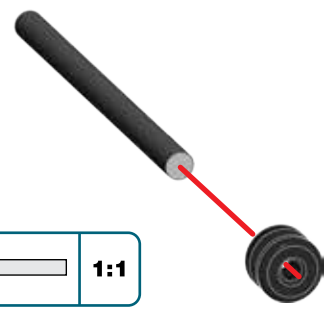

**44** (43) +

	<b>A105 (0005) X 2</b>
	<b>B051 X 1</b>
	<b>A247 (01470) X 1</b>
	<b>A337 (0037A) X 1</b>

	<span style="color: orange;">B2</span>	<b>1:1</b>
--	--	------------

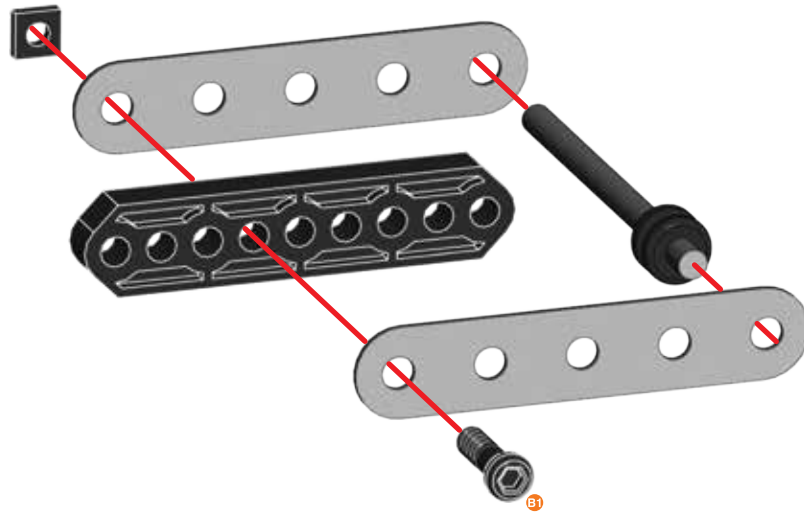

**45**

	<b>C916 X 1</b>
	<b>A806 (0806B) X 1</b>
	<b>A338 (0038B) X 1</b>
	<b>A138 (0038) X 2</b>
	<b>A247 (01470) X 1</b>
	<b>A337 (0037A) X 1</b>

	<span style="color: orange;">B1</span>	<b>1:1</b>
	<b>A338</b>	



**46**

	<b>A812 (0812B) X 1</b>
	<b>A238 (0038A) X 1</b>
	<b>A247 (01470) X 1</b>
	<b>A337 (0037A) X 1</b>

	<span style="color: orange;">B1</span>	<b>1:1</b>
	<b>A238</b>	

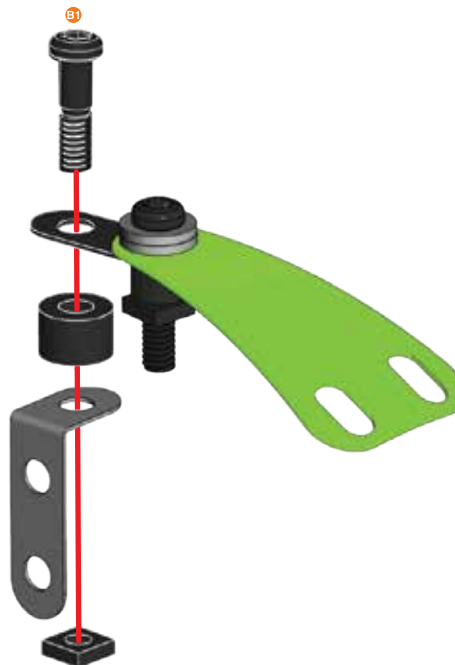

47

44 + 46 +

	<b>A238 (0038A1) X 1</b>
	<b>A447 (0147F) X 1</b> 19mm 3/4"
	<b>A337 (0037A) X 1</b>

	<b>A238</b>	<b>1:1</b>

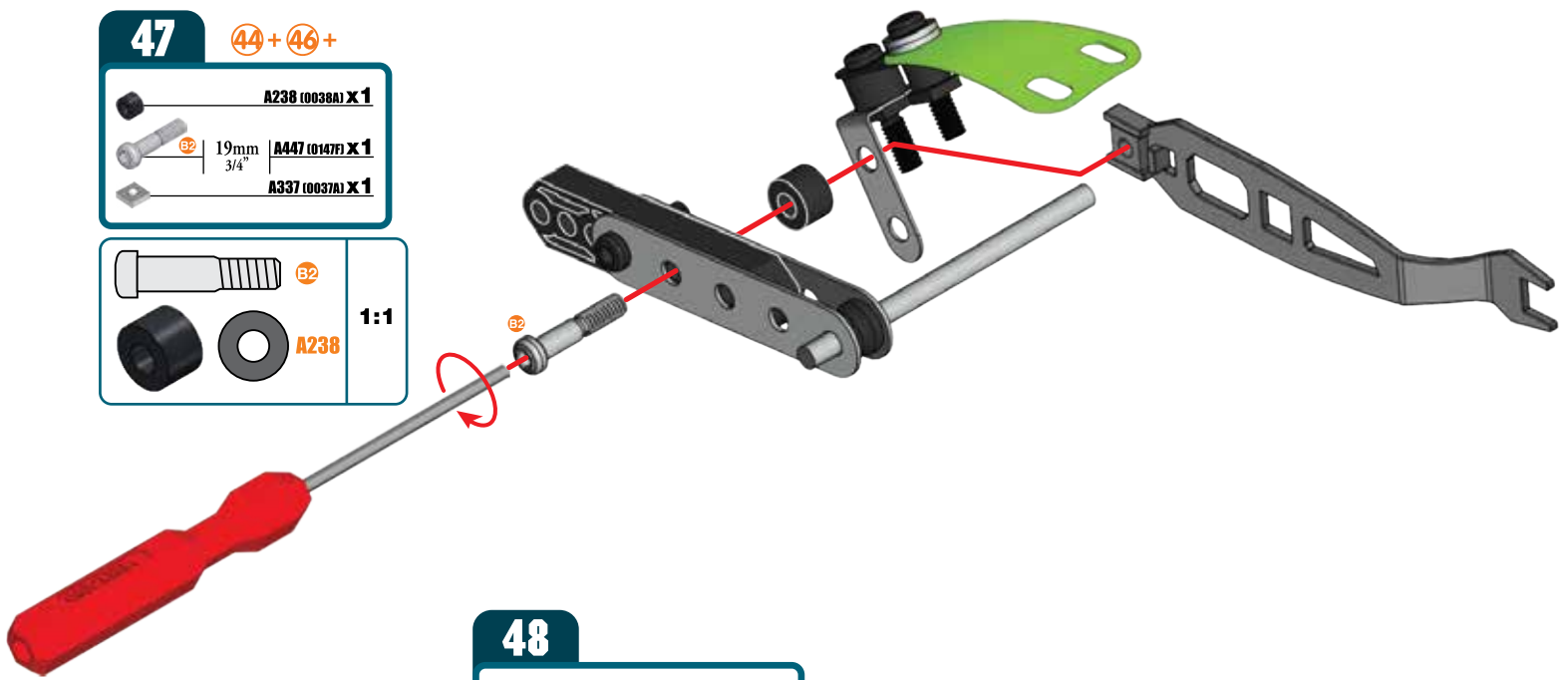

48

	<b>A017 (0017) X 1</b> 50mm 2"
	<b>A623 (0023P3C) X 1</b>

	<b>1:1</b>
--	------------



49

42 + 48



**50** (47+)

	<b>A623 (0023P36) X 1</b>
	<b>A338 (0038B) X 1</b>

		<b>A338</b>	<b>1:1</b>
---	---	-------------	------------



**51**

	<b>A259 (0059C) X 1</b>
---	-------------------------

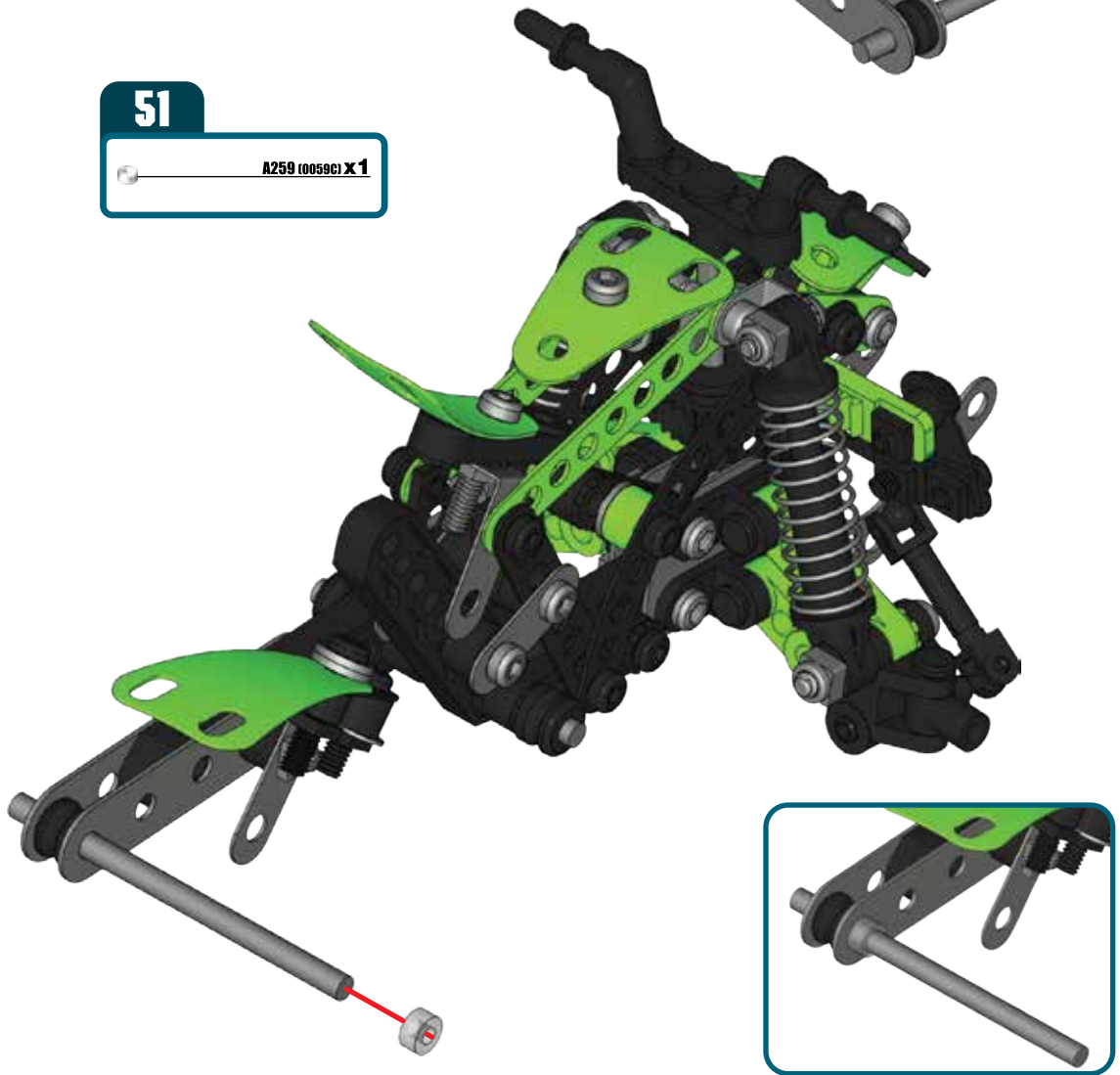

52



C890 x3



C901 x3



x3



53

51 + 52 +



C372 x1



A238 (0038A) x3





A259 (0059C) x1



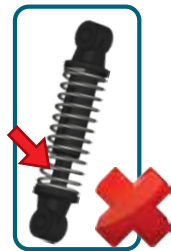
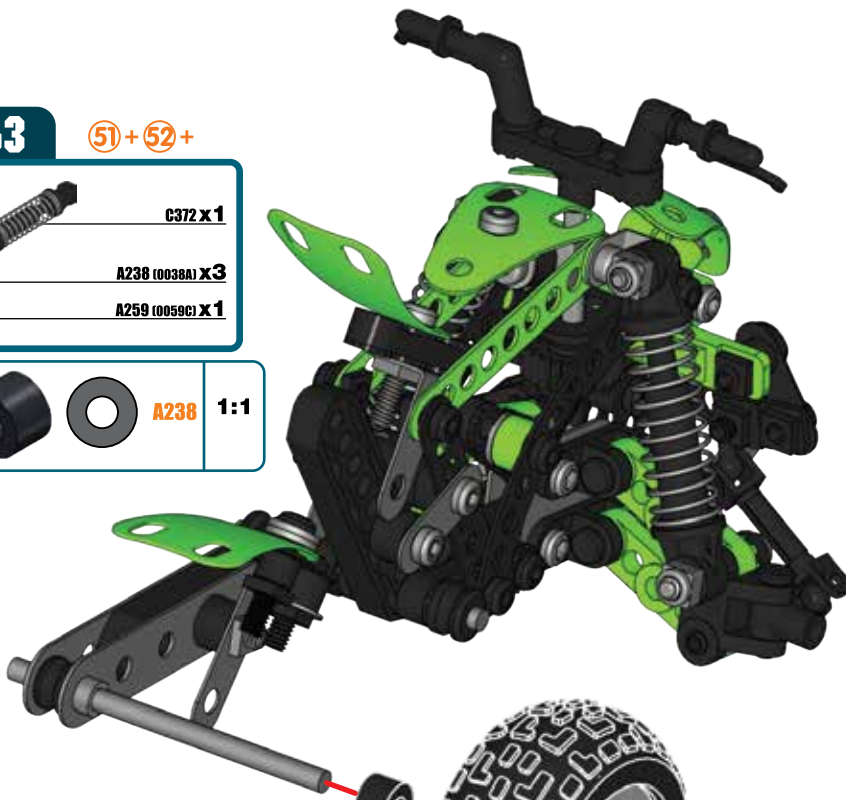

A238 1:1

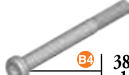



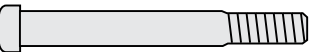

# 54

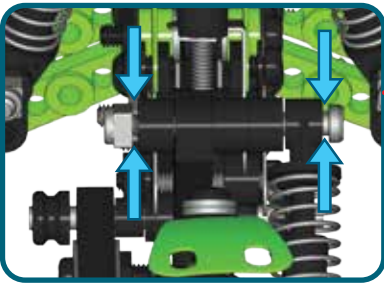
-  **B696 x1**
-  **A238 (0038A) x3**
-  **A737 (0037H) x1**

-  **B64**
  -  **A238**
- 1:1



# 55

-  **A238 (0038A) x3**
-  **B63**
-  **A347 (0111G) x1**
-  **A337 (0037A) x1**

-  **B63**
  -  **A238**
- 1:1

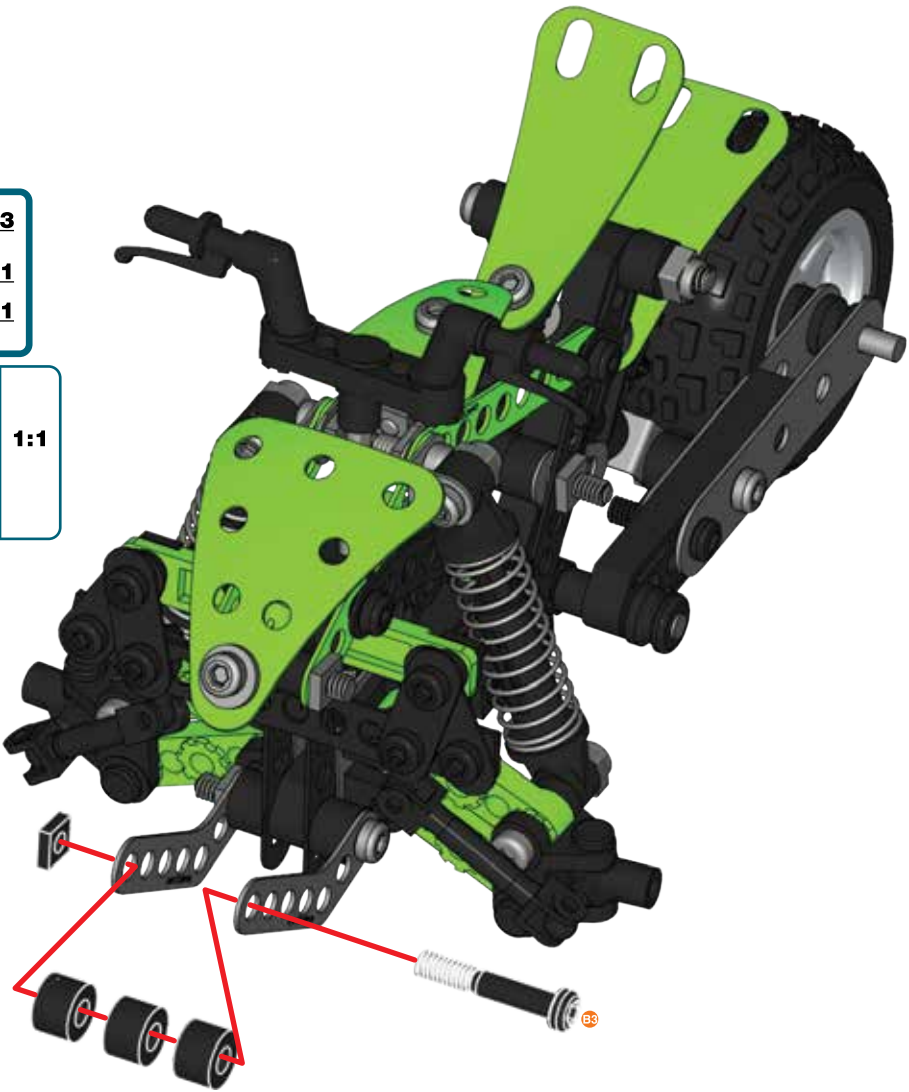

**56** 52+55+

 **B2** 19 mm **A447 (0147F) X 1**  
3/4"

 **B2** **1:1**

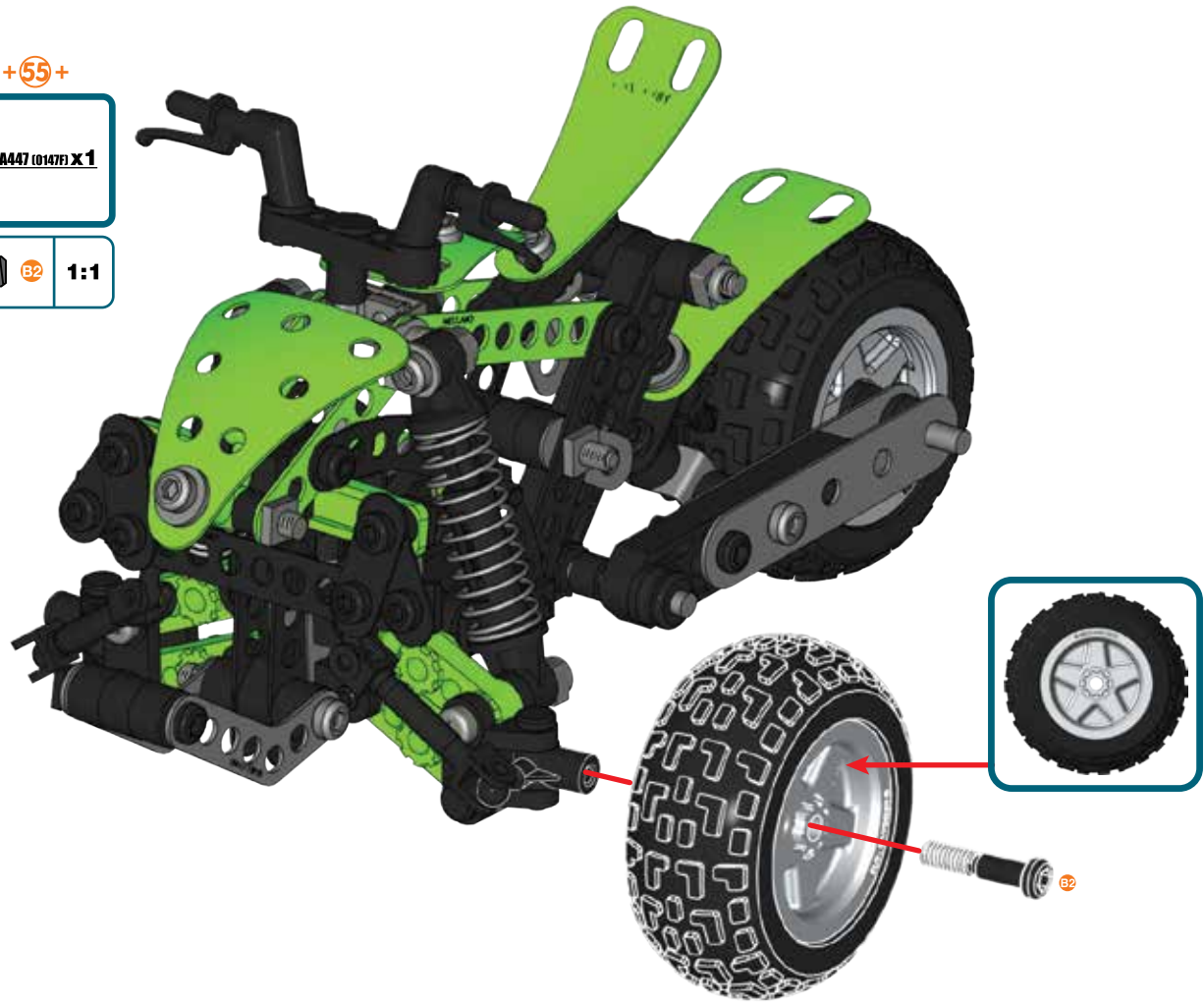

**57** 52+56+

 **B2** 19 mm **A447 (0147F) X 1**  
3/4"

 **B2** **1:1**

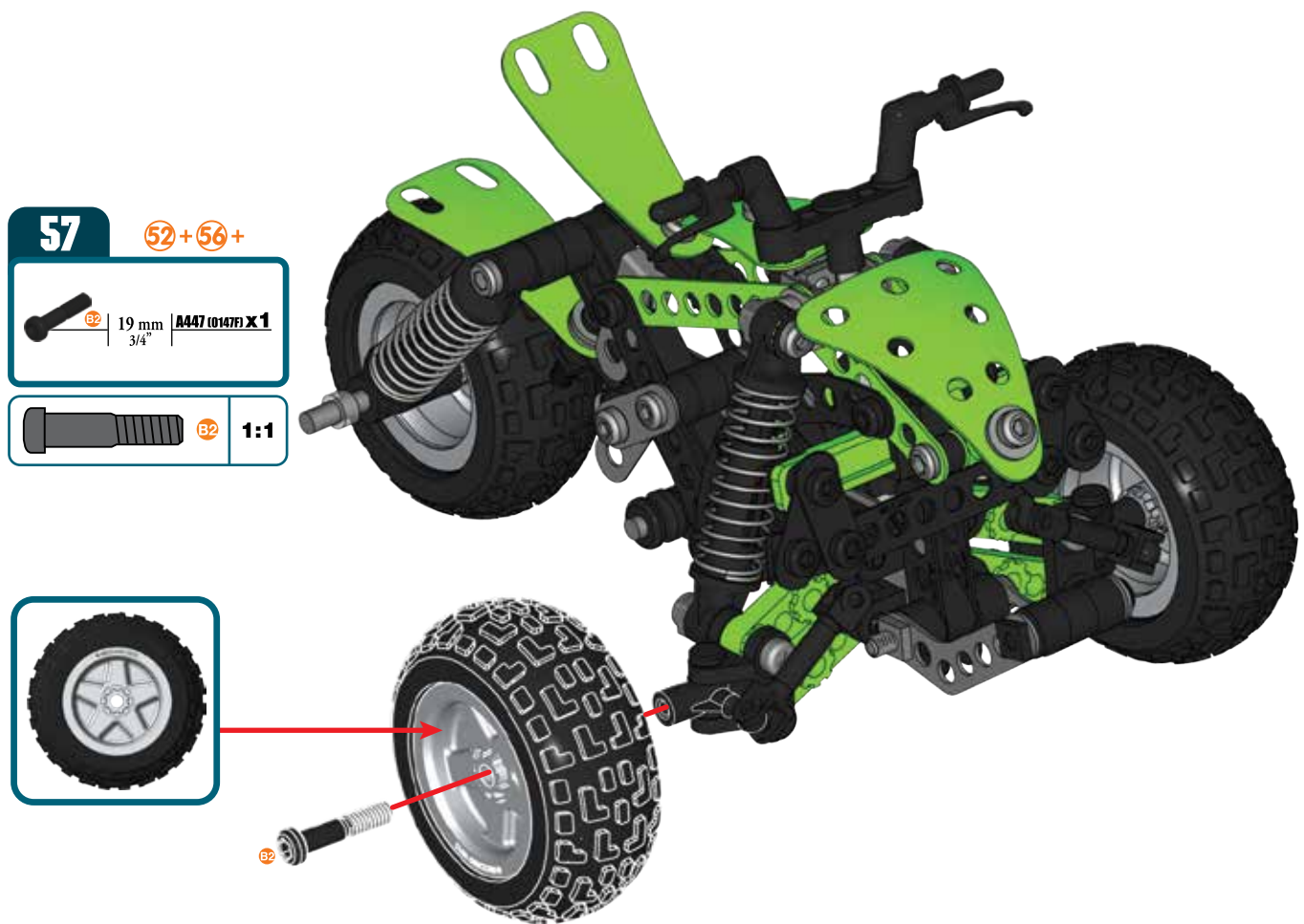

**GB** Remove all packaging before use. Retain this information, addresses and phone numbers for future reference. Content may vary from pictures. Meccano reserves the right to discontinue the website [www.meccano.com](http://www.meccano.com) at any time. An adult should periodically check this toy to ensure no damage or hazard exist if so, remove from use. Children should be supervised during play.

**F** Retirer tout l'emballage avant utilisation. Conserver les informations, adresses et numéros de téléphone pour consultation ultérieure. Le contenu peut différer des images. Meccano se réserve le droit de supprimer le site Internet [www.meccano.com](http://www.meccano.com) à tout moment. Un adulte doit régulièrement examiner ce jouet afin de s'assurer qu'il ne présente pas de dommage ni de risque. En cas de problème, ne plus l'utiliser. Les enfants doivent être surveillés lorsqu'ils jouent.

**E** Retire todo el embalaje antes de utilizar el producto. Conserve toda la información, las direcciones y los números de teléfono para futuras referencias. El contenido del paquete puede no corresponder con las imágenes. Meccano se reserva el derecho a suspender el sitio web [www.meccano.com](http://www.meccano.com) en cualquier momento. Un adulto debe revisar de forma periódica el juguete para asegurarse de que no supone un riesgo o peligro para el niño; si así fuera el caso, interrumpa su uso. Supervise a los niños mientras juegan con el producto.

**D** Entfernen Sie vor der Benutzung sämtliche Verpackungsmaterialien. Alle Informationen, Adressen und Telefonnummern bitte für mögliche Rückfragen aufbewahren. Der Packungsinhalt kann von den Bildern abweichen. Meccano behält sich das Recht vor, den Betrieb der Website [www.meccano.com](http://www.meccano.com) jederzeit einzustellen. Ein Erwachsener sollte regelmäßig sicherstellen, dass das Spielzeug keine Gefahr darstellt, und es gegebenenfalls entfernen. Kinder sollten beim Spielen beaufsichtigt werden.

**NL** Verwijder de verpakking voor gebruik. Bewaar deze informatie, adressen en telefoonnummers voor toekomstig gebruik. Inhoud kan afwijken van illustraties. Meccano behoudt zich het recht voor de website [www.meccano.com](http://www.meccano.com) wanneer gewenst buiten gebruik te stellen. Een volwassene dient dit speelgoed regelmatig te controleren op schade en gevaren. Ouderlijk toezicht is vereist als kinderen met dit speelgoed spelen.

**I** Rimuovere l'imballo prima dell'uso. Conservare informazioni, indirizzi e numeri di telefono per riferimento futuro. Il prodotto potrebbe essere differente dalle immagini. Meccano si riserva il diritto di rimuovere il sito [www.meccano.com](http://www.meccano.com) in qualsiasi momento. Il giocattolo deve essere periodicamente controllato da un adulto per prevenire eventuali danni o rischi; in caso di danno, sospendere l'uso. I bambini devono essere sorvegliati durante il gioco.

**GB** ⚠ Warning! CHOKING HAZARD - Small parts.

**F** ⚠ Attention ! RISQUE D'ÉTOUFFEMENT - Contient de petits éléments.

**E** ⚠ Advertencia: PELIGRO DE ASFIXIA - Contiene piezas pequeñas. No conveniente para niños menores de 3 años.

**D** ⚠ Achtung: ERSTICKUNGSGEFAHR - Kleinteile.

**NL** ⚠ Waarschuwing: VERSTIKKINGSGEVAAR - Kleine onderdelen.

**I** ⚠ Attenzione: RISCHIO DI SOFFOCAMENTO - Pezzi piccoli.

**P** ⚠ Aviso: PERIGO DE ASFIXIA - Peças pequenas.

**GR** ⚠ Προειδοποίηση: ΚΙΝΔΥΝΟΣ ΠΝΙΓΜΟΥ — Μικρά μέρη.

**S** ⚠ Varning: RISK FÖR KVÄVNING - Små delar.

**DK** ⚠ Advarsel: KVAELNINGSFARE - Små dele.

**FIN** ⚠ Varoitus: TUKEHTUMISVAARA - Pieniä osia.

**R** ⚠ Осторожно! ОПАСНОСТЬ УДУШЬЯ - мелкие детали.

**P** Remova totalmente a embalagem antes de utilizar. Guarde estas informações, as moradas e os números de telefone para consulta futura. O conteúdo poderá ser diferente das ilustrações. A Meccano reserva-se o direito de descontinuar o site [www.meccano.com](http://www.meccano.com) a qualquer altura. Um adulto deve verificar o brinquedo periodicamente para garantir que ele não apresenta danos ou riscos. Se houver, é necessário que o brinquedo seja retirado de uso. Crianças devem ser supervisionadas enquanto brincam.

**GR** Πριν την χρήση αφαιρέστε όλα τα υλικά της συσκευασίας. Διατηρήστε αυτές τις πληροφορίες, τις διευθύνσεις και τους αριθμούς τηλεφώνου για μελλοντική αναφορά. Το περιεχόμενο ενδέχεται να διαφέρει από τις εικόνες. Η Meccano διατηρεί το δικαίωμα να διακόψει τη λειτουργία της τοποθεσίας [www.meccano.com](http://www.meccano.com) ανά πάσα στιγμή. Ένας ενήλικας θα πρέπει να εξετάζει τακτικά αυτό το παιχνίδι και να διακόπτει τη χρήση του σε περίπτωση εντοπισμού βλαβών ή κινδύνων. Τα παιδιά θα πρέπει να παίζουν υπό επίτηρηση.

**S** Ta bort alla förpackningar före användning. Spara den här informationen, adresser och telefonnummer för framtida referens. Innehållet kan skilja sig från bilderna. Meccano förbehåller sig rätten att när som helst ta bort webbplatsen [www.meccano.com](http://www.meccano.com). En vuxen ska regelbundet undersöka den här leksaken för att säkerställa att det inte finns några skador eller faror rörande den. Barn ska hållas under uppsikt när de leker.

**DK** Fjern al emballage før brug. Gem disse oplysninger, adresser og telefonnumre for fremtidig brug. Indholdet kan være forskelligt fra billederne. Meccano forbeholder sig ret til at nedlægge hjemmesiden [www.meccano.com](http://www.meccano.com) til enhver tid. En voksen bør jævnligt tjekke dette legetøj for at sikre, at det ikke er beskadiget eller udgør nogen fare, i så fald, stop brugen af det. Børn bør overvåges, når de leger med det.

**FIN** Poista kaikki pakkausmateriaali ennen käyttöä. Säilytä nämä tiedot, osoitteet ja puhelinnumerot tulevia tarpeita varten. Sisältö saattaa poiketa kuvista. Meccano pidättää oikeuden lakkauttaa sivuston [www.meccano.com](http://www.meccano.com) milloin tahansa. Aikuisen tulee säännöllisesti tarkistaa, että lelu ei ole vaurioitunut ja muuttunut vaaralliseksi. Jos näin on käynyt, lelu tulee poistaa käytöstä. Lasten tulee leikkiä vain aikuisen valvonnassa.

**R** Снимите все упаковочные материалы перед использованием. Запишите указанные на упаковке адреса и номера телефонов, чтобы у вас была возможность связаться с нами. Содержимое упаковки может отличаться от иллюстрации. Компания Meccano оставляет за собой право прекратить использование сайта [www.meccano.com](http://www.meccano.com) в любое время. Взрослым следует время от времени проверять игру и следить за тем, чтобы она не была сломана и не представляла опасности для ребенка. В противном случае ее не следует использовать. Во время игры за детьми следует присматривать.



UK – 0800 206 1191, [SERVICEUK@SPINMASTER.COM](mailto:SERVICEUK@SPINMASTER.COM)  
FRANCE – 0800 909 150, [SERVICEFR@SPINMASTER.COM](mailto:SERVICEFR@SPINMASTER.COM)  
ESPAÑA – [SERVICIO@SPINMASTER.COM](mailto:SERVICIO@SPINMASTER.COM)  
DEUTSCHLAND – 00800 0101 0222, [KUNDENSERVICE@SPINMASTER.COM](mailto:KUNDENSERVICE@SPINMASTER.COM)  
SCHWEIZ – 0800 561 350 • ÖSTERREICH – 0800 29 72 67  
NEDERLAND – 0800 022 36 83, [KLANTENSERVICE@SPINMASTER.COM](mailto:KLANTENSERVICE@SPINMASTER.COM)  
BELGIË/BELGIQUE – 0800 77 688 • LUXEMBOURG – 800 28 044  
ITALIA – 800 788 532, [SERVIZIO@SPINMASTER.COM](mailto:SERVIZIO@SPINMASTER.COM)  
MEXICO – 53.51.44.00

[WWW.SPINMASTER.COM](http://WWW.SPINMASTER.COM)

NORTH AMERICA : 1-800-622-8339 customercare@spinmaster.com  
AMÉRIQUE DU NORD :

TM & © 2015 MECCANO for packaging, instructions and models built with this set. TM & © 2015 MECCANO pour l'emballage, les notices et modèles de ce coffret. © MECCANO is an exclusive trademark of MECCANO. Spin Master logo is a trademark of Spin Master Ltd. © MECCANO est une marque de commerce exclusive de MECCANO. Le logo de Spin Master est une marque de commerce de Spin Master Ltd. All rights reserved. Tous droits réservés.

T91778\_0002\_20070950\_GML\_IB\_R1W2\_MEC\_Vehicle

SPIN MASTER LTD., 450 FRONT STREET WEST, TORONTO, ON M5V 1B6 CANADA.  
Distributed in EU by SPIN MASTER INTERNATIONAL, S.A.R.L.,  
16 AVENUE PASTEUR, L-2310, LUXEMBOURG.  
[www.spinmaster.com](http://www.spinmaster.com)

