

MECCANO®



LEAFLET
ANLEITUNG
ISTRUZIONI
BROSCHYR
OHJEET
VEJLEDNING

NOTICE
INSTRUCCIONES
BESCHRIJVINGEN
INSTRUCOES
ΟΔΗΓΙΕΣ
説明書

3920

P. 4 - 6



P. 7 - 10



P. 11 - 14



P. 15 - 17



P. 18 - 20



P. 21 - 23



P. 24 - 27



P. 28 - 31



48 Many of the models and component parts are unique and original designs which are the property of MECCANO S.A. They are protected by Italian legislation as industrial designs. Inventions and/or copyrights throughout many countries. For detailed information, please contact MECCANO S.A. MECCANO takes the responsibility where instructions have not been followed, where glasses have been put in, or when other than those in the instructions, or when modified models are produced.

5 Om många modeller och delar tillhör ett unikt och original utformning, vilken är MECCANO S.A. s ända egendom och skyddas enligt de lagar som gäller i varje land. MECCANO S.A. tar ansvaret för de instruktioner som inte följs, när glasögon sätts på, eller när andra delar än de som anges i de instruktionerna, eller när modifierade modeller tillverkas.

6 Zestawa modeli i części jest unikatowa i oryginalna, projektowana przez MECCANO S.A. i jest ona własnością i jest ona chroniona przez prawo w każdym państwie. MECCANO S.A. bierze odpowiedzialność, jeżeli instrukcje nie zostały przestrzegane, jeżeli okulary zostały założone, lub jeżeli użyto części innych niż te, które są wymienione w instrukcjach. MECCANO S.A. nie odpowiada za modyfikacje modeli.

7 Ilustrazioni modelli e parti sono uniche e originali, progettate dalla MECCANO S.A. e sono protette dalle leggi relative alla proprietà intellettuale in ogni paese. MECCANO S.A. assume la responsabilità qualora le istruzioni non vengono seguite, se parti componenti vengono impiegate in modo diverso da quello illustrato o siano state modificate per un differente del montaggio del modello MECCANO.

8 Många modeller och delar tillhör ett unikt och original utformning, vilken är MECCANO S.A. s ända egendom och skyddas enligt de lagar som gäller i varje land. MECCANO S.A. tar ansvaret för de instruktioner som inte följs, när glasögon sätts på, eller när andra delar än de som anges i de instruktionerna, eller när modifierade modeller tillverkas.

9 Vore mnage modeler og dele tilhør et originalt fremstilling og er det MECCANO S.A. s egendom og beskyttes af lovgivningen i hvert land. MECCANO S.A. bærer ansvaret for de instruktioner som ikke følges, når glasögon sættes på, eller når andre dele end de som er nævnt i de instruktioner, eller når modificerede modeller tilvirket.

10 Uzun model ve parçaları MECCANO S.A. s mülkiyetinde olan orijinal tasarımlardır. MECCANO S.A. bu tasarımların her türlü haklarını korumaktadır ve bunları her ülkedeki yasal düzenlemelerle korumaktadır. MECCANO S.A. talimatları takip edilmezse, gözlükler takılırsa veya talimatlar dışında parçalar kullanılırsa, modelin değiştirilirse veya değiştirilmiş modeller üretilirse MECCANO S.A. sorumlu değildir.

11 Modeler og deler er unikt og originalt udformet, og er MECCANO S.A. s ejendomme og beskyttes af lovgivningen i hvert land. MECCANO S.A. bærer ansvaret for de instruktioner som ikke følges, når glasögon sættes på, eller når andre dele end de som er nævnt i de instruktioner, eller når modificerede modeller tilvirket.

12 Modeler og deler er unikt og originalt udformet, og er MECCANO S.A. s ejendomme og beskyttes af lovgivningen i hvert land. MECCANO S.A. bærer ansvaret for de instruktioner som ikke følges, når glasögon sættes på, eller når andre dele end de som er nævnt i de instruktioner, eller når modificerede modeller tilvirket.

13 Modeler og deler er unikt og originalt udformet, og er MECCANO S.A. s ejendomme og beskyttes af lovgivningen i hvert land. MECCANO S.A. bærer ansvaret for de instruktioner som ikke følges, når glasögon sættes på, eller når andre dele end de som er nævnt i de instruktioner, eller når modificerede modeller tilvirket.

14 Modeler og deler er unikt og originalt udformet, og er MECCANO S.A. s ejendomme og beskyttes af lovgivningen i hvert land. MECCANO S.A. bærer ansvaret for de instruktioner som ikke følges, når glasögon sættes på, eller når andre dele end de som er nævnt i de instruktioner, eller når modificerede modeller tilvirket.

15 Modeler og deler er unikt og originalt udformet, og er MECCANO S.A. s ejendomme og beskyttes af lovgivningen i hvert land. MECCANO S.A. bærer ansvaret for de instruktioner som ikke følges, når glasögon sættes på, eller når andre dele end de som er nævnt i de instruktioner, eller når modificerede modeller tilvirket.



1



2



3



[189] X 1



[188] X 2



[221] X 2



[51a] X 2



[48a] X 2



[11] X 2



[825] X 4



[812d] X 2



[23bP] X 3



[2a] X 4



[235d] X 5



[235a] X 2



[235] X 2



[235h] X 2



[235g] X 6



[5] X 2



[6a] X 3



[12b] X 2



[10] X 2



[12c] X 4



[12] X 8



[38a] X 10



[38b] X 2



[7] [142] X 3

[1] [28] X 0

[2] [18] X 2

[3] [12] X 7

[4] [8.5] X 0

[37b] X 36

[37a] X 47

[142j] X 3

[36c] X 1

[34] X 1



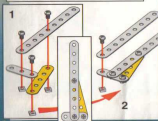
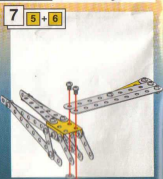
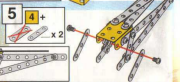
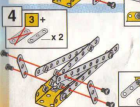
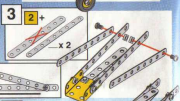
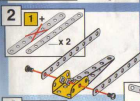
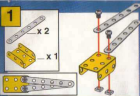

8

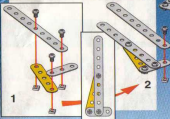

9

7+8

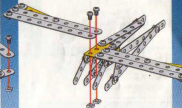

10

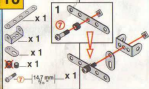

12

9+11+

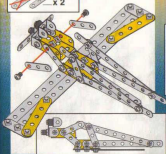

11

10+

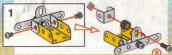
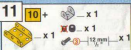

13

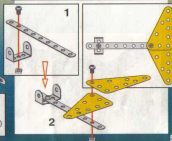

14 x 2
 x 2
 | 14,7 mm | x 2
 x 2
 x 2

15 **14** +
 x 2
 x 2
 x 2
 x 2

16 **12** + **13** + **15** +
 x 2
 | 12 mm | x 2

16 **12** + **13** + **15** +
 x 2
 | 12 mm | x 2

17 **16** + x 2
 | 16 mm | x 1
 x 2

18 **17** + x 2
 x 1
 x 1
 | 13 mm | x 1

17 **16** + x 2
 | 16 mm | x 1
 x 2

18 **17** + x 2
 x 1
 x 1
 | 13 mm | x 1

1

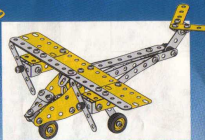
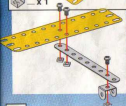

2

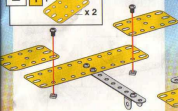

3

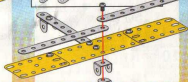

4

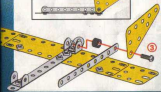

5

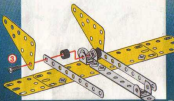

6 **5** +  x 2

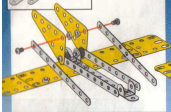

7 **6** +  x 2

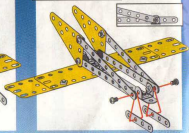



8   x 1
 x 2

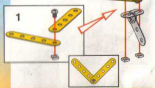

9 **8** +  x 2



10 **7** + **9** +   x 2
 | 19 mm | x 1

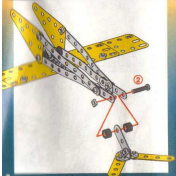

11  x 1  | 14 7/8 mm | x 1
 x 1  x 1  x 1

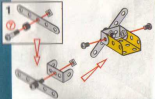

12 10 + 11

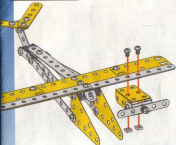

13

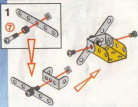
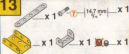

14 12 + 13

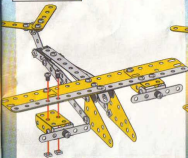

15

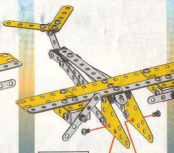
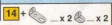

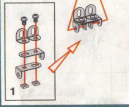
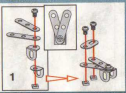

16

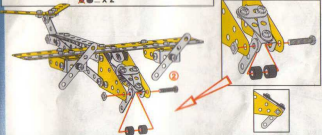

17 15 + 16 +  x 1  (2) | 12 mm | x 1
 x 2



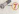

18  x 3
 x 3  (7) | 14.7 mm | x 3

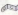

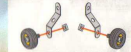
19 18 +  x 2

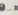



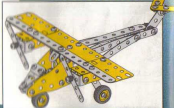
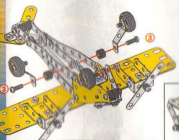

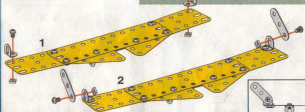
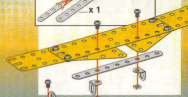
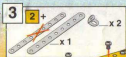
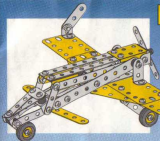

20 19 +  x 2  (3) | 12 mm | x 2



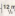

5

-  x 1
-  x 2
-  x 1
-  x 1
-  x 1
-  x 1

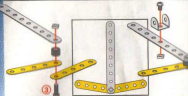

6

-  x 1
-  x 1



7

- 6** +  x 1
-  x 1
-  x 1

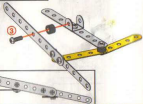

8

-  x 1
-  x 1







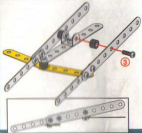

9

- 8** +  x 1
-  x 1
-  x 1

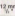

10

-  x 2
-  x 1
-  x 2
-  x 2
-  x 2
-  x 2
-  x 1

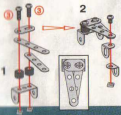

11 9 + 10 +

 x 1

 x 2

 (12 mm) x 1

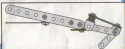
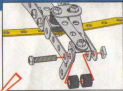
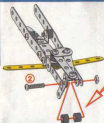

12

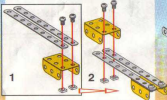

13 12 +

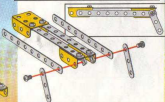

14 11 + 13

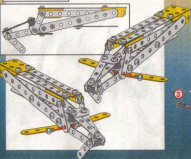

15 14 +



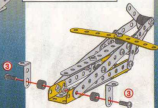

 x 2

 x 2

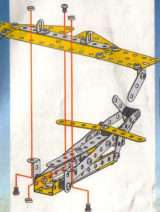



16 4 + 15

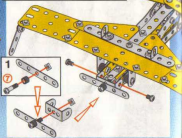

17 16 +  x 1  x 1
 x 1  $\frac{14,7}{\text{mm}}$ x 1



18  x 3  x 3
 $\frac{14,7}{\text{mm}}$ x 3



19 18 +  x 2



20 17 + 19

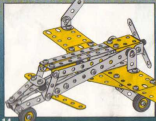
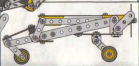
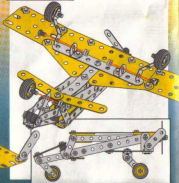

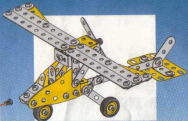
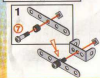
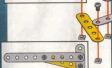
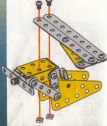
1**2****3****4****5****6****7****8**

9

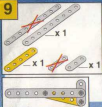

10

9+

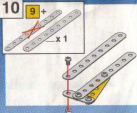

11

8 + 10

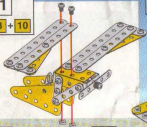

12

11+

x1

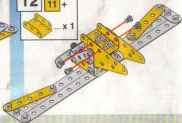

13

x1
x2

14

12 + 13 + x1

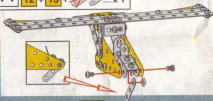

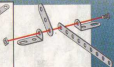

15

x1
x1
x2

16

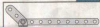
x1

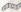

17 14 + 16 +  x 1  x 2

 (2) | 19 mm | x 1

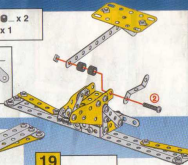
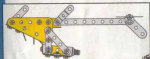

18  x 2

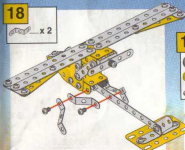

19

 x 3

 x 3

 (7) | 14,7 mm | x 3



20 18 + 19

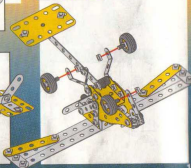
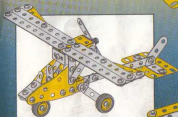
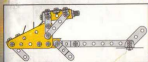

1
_x1
_x1



2
_x1
_x2

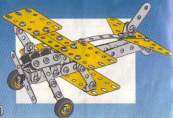
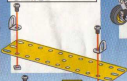

3 **1** + **2** +
_x1

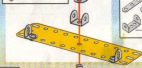

4
_x4
_x2



5 **3** + **4**

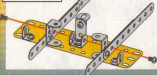

6
_x1
_x1
_x1
_x1



7 **6** +
_x1
_x1

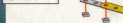

8
_x1

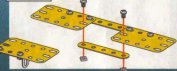

9 **8** +  $\frac{12}{16}$ mm x 1
 x 2

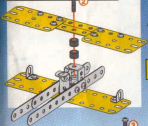

10  x 2



11  x 2
 x 1
 x 2
 $\frac{12}{16}$ mm x 2



12 **11** +
 x 1
 x 1
 x 1
 $\frac{12}{16}$ mm x 1

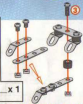

13 **10** + **12** +
 x 1

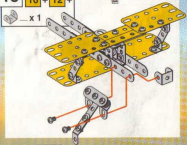

14  x 2
 x 1
 x 2
 $\frac{12}{16}$ mm x 2



16 **13** + **15**

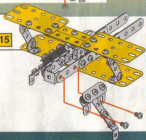

15 **14** +
 x 1
 x 1
 x 1
 $\frac{12}{16}$ mm x 1



17

 x 1
 x 1
 x 1

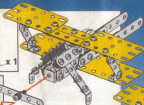
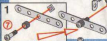
**18** **17** +  x 2

 x 1  x 1
 x 1

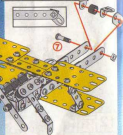
**19**

 x 2
 x 1
 x 1

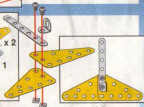
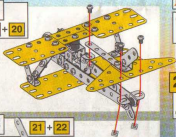
**21****18** + **20****20****19** +  x 1

 x 1  x 1

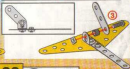
**22** x 2 x 2

 x 2

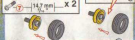
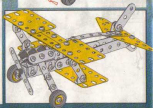
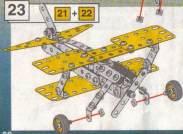
**23****21** + **22**

1

x 1
x 2

2 **1** +

x 1

3

x 1
x 1
x 1
x 1 (12 mm)



4 **3** +

x 2

5

x 1
x 1

6 **4** + **5** +

x 2

1

2

7

x 1
x 1
x 1 (12 mm)

1

8 **7** +

x 1
x 1
x 1 (12 mm)

1

9



10 9 +



11 8 + 10



12

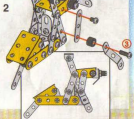
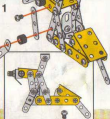

13

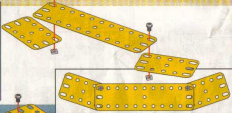

14 13 +

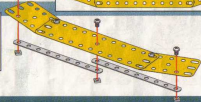

15 14+

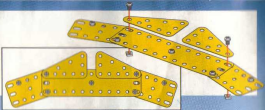

16



17 12+16

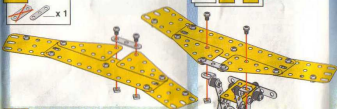

18



19 17+18

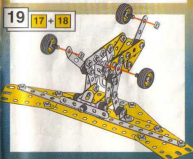

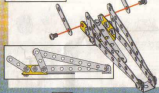
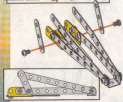
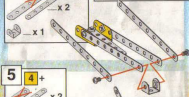
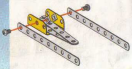
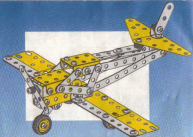

8 5 + 7 +

- x 2
- x 1

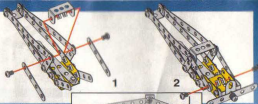

9 x 1 x 1

- x 2
- x 1

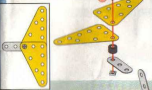

10 8 + 9 + x 1

- x 1
- x 1

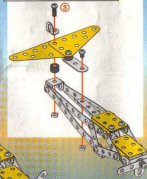

11 10 + x 1

- x 1
- x 1



12 x 1 x 2

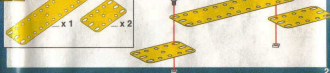

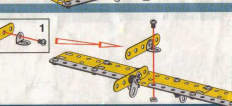
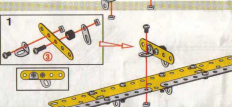
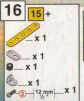
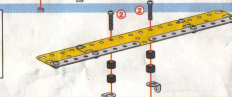
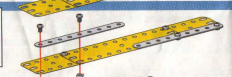

18 11 +  - x 1

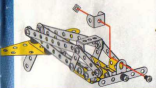

19 17 + 18

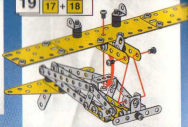

20  - x 3

 - x 3

 - x 3



1   

21 20 +

  - x 1



22 20 + 21 +  - x 1

 - x 1

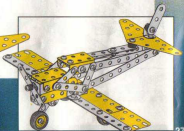

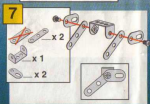
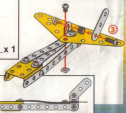
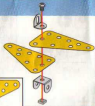
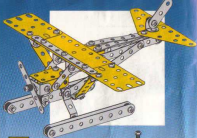
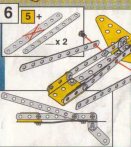
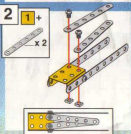
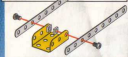

8 **6** + **7** +

 x 2

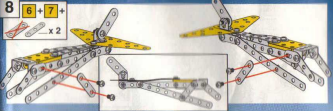

9

 x 1
 x 1
 x 1

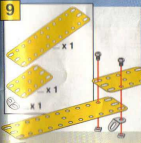

10

9 +  x 1  x 1

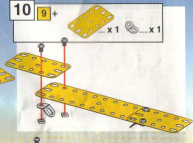

11

10 +  x 1

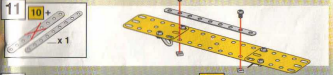

12

8 + **11**

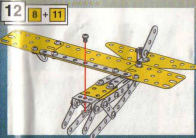

13

 x 2  x 2

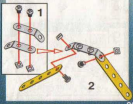

14 **12 + 13**

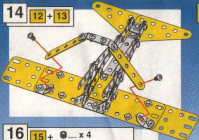

15

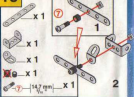

16 **15 +** ● — x 4
 (2) — (19 mm) — x 2

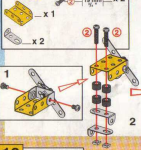

17 **14 + 16**

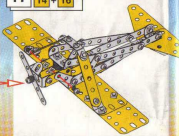

18

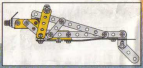
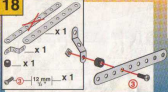

19 **18 +**



20 17 + 19

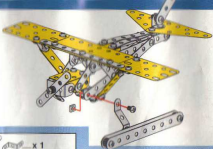

21



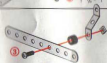

22 21 +





23

20 + 22

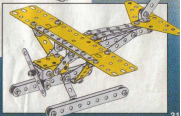
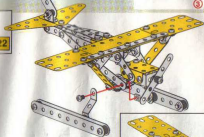

- 88 GLOSSARI
- F LEXIQUE
- D TEILE-LISTE
- I LESSICO
- S DETALJ BESKRIVNING
- SF ŠANAKIRJA
- DK ORDLISTE
- E NOMENCLATURAS
- NL ONDERDELENLIJST
- P GLOSSARIO
- GR ΓΛΩΣΣΑΡΙ
- PH 用語集

MECCANO

<p>Perforated strip - 9 holes Bando à 9 furos Luchband Bando à 9 buchi Längsleiste à 9 löcher Supporte strip</p>  <p>Flanone a 9 buchi Bando à 9 passos Gegenspanne streifen à 9 ganz Fila perforada à 9 furos Luchband a 9 buchi Supporte à 9 trous Лента с 9 отверстиями</p>	<p>Double angle strip Bando coadunato Stabdak-verbinder Bando a goriz Dubbelt verticaal balk Kaksobolusna lesta</p>  <p>Anglo sliders à 4 holes Corredor à 4 furos Winkelgleiter Prestine à 4 à 4 buci Vinkelrolle à 4 gaatjes Kulmsruijder</p>  <p>Flat plate Plaqueta rigida Piastr. Plastr Plastre rigida Halvplatta, platt Jerdatta leevija</p>  <p>Double plate Plaqueta bicamada Plastre Plastr Plastre bicamada Baldy plastr Dvukratnaya leevija</p>  <p>Strong flexible plate Plaqueta bicamada triangulada Halvplatta driehoek. Plastr Plastre bicamada triangulada Baldy triangelnaya Kaksobolusna bicamada trokutna leevija</p>  <p>Flange motor plate Plaque à rebord Winkelplastr Plastre con bord Vinkelplaat Kulmsruijder</p>  <p>Roller plate Support plat Flexorolista Supporte plate Stuipplaat Linda rollebander</p>  <p>Anglo bracket 90° (120°) Esquina 90° (120°) 90° (120°) Winkelbrak Esquina 90° à 120° Vinkelplaat 90 Kulmsruijder 90° (120°)</p> 	<p>Straps a 4 holes Fureto à 4 passos Gegenspanne riemen à 4 ganz Fila perforada à 4 furos Luchband a 4 buchi Supporte a 4 trous Лента с 4 отверстиями</p>  <p>Unidirectional Vedlo jednolozna Dubbelt flenskrand Pecia de carcasa diptera Kaksobolusna jeksobolna trapezoidna Лента с 4 отверстиями</p>  <p>Hexagonal strip à 4 holes Cureto à 4 passos Hexadruplo à 4 ganz Canco à 4 furos Fuste per à 4 gajetes Шестиголь с 4 отверстиями</p>  <p>Four plate Plaque rigida Plastr plastr Plastre rigida Ampersone ridnate Четыре глыбы</p>  <p>Single plate Plaque flexible Plastre flexible Plastre plastr Plastre flexivel Elastoanalo ridnate Четыре глыбы</p>  <p>Trapezoidal, double plate Plaque flexible y triangulada Halvplatta driehoek. plastr Plastre flexible triangulada Baldy trojnagolnaya Kaksobolusna trojnagolnaya Четыре глыбы</p>  <p>Rectangle Plaque con rebord Flexorol. Pecia con rebord Kaksobolusna jeksobolna trapezoidna Лента с 4 отверстиями</p>  <p>Rectangle Supporte forme Rektangul. Supporte en plastr Rektangul. Лента с 4 отверстиями</p>  <p>Triangle Plaque a 3 trous Gegenspanne dreieck. riemen Fila triangulara Luchband a 3 buchi Supporte triangle Треуголь с 3 отверстиями</p>  <p>Circle Plaque a 4 trous Gegenspanne vierkant. riemen Fila cuadrada Luchband a 4 buchi Supporte quadrado Квадрат с 4 отверстиями</p>  <p>Circle Plaque a 4 trous Gegenspanne vierkant. riemen Fila cuadrada Luchband a 4 buchi Supporte quadrado Квадрат с 4 отверстиями</p>  <p>Square Plaque a 4 trous Gegenspanne vierkant. riemen Fila cuadrada Luchband a 4 buchi Supporte quadrado Квадрат с 4 отверстиями</p>  <p>Circle Plaque a 2 trous Gegenspanne twee-kant. riemen Fila bialv. Luchband a 2 buchi Supporte bialv. Квадрат с 2 отверстиями</p>  <p>Circle Plaque a 2 trous Gegenspanne twee-kant. riemen Fila bialv. Luchband a 2 buchi Supporte bialv. Квадрат с 2 отверстиями</p> 
---	---	--

<p>Rearrest angle bracket Esquina revesada Fleksorolista Supporte revesado Dubbeltflens Kaksobolusna</p>  <p>Corner bracket Peca. puzor. d'arremilhoje Katur. zvezkovidn. Pecia. puzor. d'arremilhoje Katur. zvezkovidn.</p>  <p>Acid nail Tregla Tregpa Barva Kvaz. Kaksobolusna</p>  <p>Padlock Palouk Zakles. Palouk Kamand. Hlasovojk. Kamand. Zakles. Kamand.</p>  <p>Screw Buzer. Fureto Halvdrup. Anillo de anovaca I. stepen. Trazopriklad.</p>  <p>Washer Kamand. Lothsvilben Kamand. Buzer. Prilozak.</p>  <p>Spacer Dizoznaca Sag. Brida di collegamento Dizoznaca Vinkelpl. Kaksobol.</p>  <p>Small ball Bodoin. puzor. Zapuzor. d'arremilhoje Buzer. puzor. Skladok. Hlasovojk. kaksobolusna</p>  <p>Grab screw Vita. (puzor. d'arremilhoje) Flexorolista Vite. (puzor. d'arremilhoje) Skriz. Buzer. (puzor. d'arremilhoje)</p>  <p>Square nut Doblo. zvezk. Vinkelzvezk. Doblo. zvezk. Trazopriklad. Kamand.</p>  <p>Clamp Clamp. svedn. d'arremilhoje Clamp. svedn. d'arremilhoje Clamp. svedn. d'arremilhoje Hlasovojk. Kaksobolusna</p>  <p>Allen key Kli. d'arremilhoje Schluss. d'arremilhoje Clamp. svedn. d'arremilhoje Schluss. d'arremilhoje Kaksobolusna</p> 	<p>Diamond wheel Krupn. d'arremilhoje Krupn. d'arremilhoje Krupn. d'arremilhoje Krupn. d'arremilhoje Krupn. d'arremilhoje</p>  <p>Hexagonal nut Katur. zvezk. vidn. d'arremilhoje Katur. zvezk. vidn. d'arremilhoje Katur. zvezk. vidn. d'arremilhoje Katur. zvezk. vidn. d'arremilhoje</p>  <p>Hexagonal screw Katur. zvezk. vidn. d'arremilhoje Katur. zvezk. vidn. d'arremilhoje Katur. zvezk. vidn. d'arremilhoje Katur. zvezk. vidn. d'arremilhoje</p>  <p>Hexagonal bolt Katur. zvezk. vidn. d'arremilhoje Katur. zvezk. vidn. d'arremilhoje Katur. zvezk. vidn. d'arremilhoje Katur. zvezk. vidn. d'arremilhoje</p>  <p>Hexagonal nut Katur. zvezk. vidn. d'arremilhoje Katur. zvezk. vidn. d'arremilhoje Katur. zvezk. vidn. d'arremilhoje Katur. zvezk. vidn. d'arremilhoje</p>  <p>Hexagonal screw Katur. zvezk. vidn. d'arremilhoje Katur. zvezk. vidn. d'arremilhoje Katur. zvezk. vidn. d'arremilhoje Katur. zvezk. vidn. d'arremilhoje</p>  <p>Hexagonal bolt Katur. zvezk. vidn. d'arremilhoje Katur. zvezk. vidn. d'arremilhoje Katur. zvezk. vidn. d'arremilhoje Katur. zvezk. vidn. d'arremilhoje</p>  <p>Hexagonal nut Katur. zvezk. vidn. d'arremilhoje Katur. zvezk. vidn. d'arremilhoje Katur. zvezk. vidn. d'arremilhoje Katur. zvezk. vidn. d'arremilhoje</p>  <p>Hexagonal screw Katur. zvezk. vidn. d'arremilhoje Katur. zvezk. vidn. d'arremilhoje Katur. zvezk. vidn. d'arremilhoje Katur. zvezk. vidn. d'arremilhoje</p>  <p>Hexagonal bolt Katur. zvezk. vidn. d'arremilhoje Katur. zvezk. vidn. d'arremilhoje Katur. zvezk. vidn. d'arremilhoje Katur. zvezk. vidn. d'arremilhoje</p>  <p>Hexagonal nut Katur. zvezk. vidn. d'arremilhoje Katur. zvezk. vidn. d'arremilhoje Katur. zvezk. vidn. d'arremilhoje Katur. zvezk. vidn. d'arremilhoje</p>  <p>Hexagonal screw Katur. zvezk. vidn. d'arremilhoje Katur. zvezk. vidn. d'arremilhoje Katur. zvezk. vidn. d'arremilhoje Katur. zvezk. vidn. d'arremilhoje</p> 
---	---

© MECCANO S.p.A. - Milano - Italy - 1985 - Made in France by I. H. S. - Paris - France